

SITE CONSTRUCTION PLANS

FOR

GULF BEACH SELF STORAGE

8939 GULF BEACH HIGHWAY

ESCAMBIA COUNTY, FLORIDA

January 2022

RBA PROJECT NO.: 2017.285

ECUA REQUIRED PLAN NOTES
(NOTES SHALL BE INSERTED IN THE UPPER RIGHT CORNER OF TITLE SHEET)

A. ECUA ENGINEERING MANUAL INCORPORATED BY REFERENCE

THE ECUA ENGINEERING MANUAL, DATED DECEMBER 18, 2014, ALONG WITH ANY LISTED UPDATES HEREINAFTER "MANUAL", LOCATED AT WWW.ECUA.FL.GOV, IS HEREBY INCORPORATED BY REFERENCE INTO THIS PROJECT'S OFFICIAL CONTRACT DOCUMENTS AS IF FULLY SET FORTH THEREIN. IT IS THE CONTRACTOR'S RESPONSIBILITY TO BE KNOWLEDGEABLE OF THE MANUAL'S CONTENTS AND TO CONSTRUCT THE PROJECT IN ACCORDANCE WITH THE MANUAL. THE CONTRACTOR SHALL PROVIDE HIS EMPLOYEES ACCESS TO THE MANUAL AT ALL TIMES, VIA PROJECT SITE OR OFFICE, VIA DIGITAL OR PAPER FORMAT. IN THE EVENT OF A CONFLICT BETWEEN THE MANUAL AND THE PLANS, CONTRACTOR SHALL CONSULT ENGINEER OF RECORD ON THE APPROPRIATE RESOLUTION.

B. ADDITIONAL DOCUMENTS (TO BE COMPLETED BY THE ENGINEER OF RECORD)

DOES THIS PROJECT HAVE ADDITIONAL TECHNICAL SPECIFICATIONS OR CONSTRUCTION DETAILS THAT SUPERSEDE THE MANUAL LISTED ABOVE?

YES NO

IF YES, CONTRACTOR SHALL CONSTRUCT PROJECT IN ACCORDANCE WITH SAID DOCUMENTS AS LISTED AND LOCATED BELOW:

DOCUMENT NAME	DOCUMENT TYPE		LOCATION	
	SPECIFICATION	DETAIL	PLANS	PROJECT MANUAL*
LOW PRESSURE SEWER SERVICE: D-20		X	X	

*PROJECT MANUALS USED ONLY WITH ECUA CIP PROJECTS

C. ENGINEER OF RECORD RESPONSIBILITIES

THE ENGINEERS OF RECORD (EORS) THAT HAVE AFFIXED THEIR SEALS AND SIGNATURES ON THESE PLANS WARRANT THEIR PORTION OF THE PLANS HAVE BEEN DESIGNED IN ACCORDANCE WITH THE MANUAL (UNLESS OTHERWISE DIRECTED BY THE ECUA PROJECT ENGINEER). THE EORS SHALL BE KNOWLEDGEABLE OF THE MANUAL'S CONTENTS AND SHALL ASSUME RESPONSIBILITY FOR ITS USE ON THIS PROJECT.

SITE INFORMATION	
OWNER:	GULF BEACH SELF STORAGE, INC 3886 PARADISE BAY DRIVE GULF BREEZE, FLORIDA 32563 850-982-4411
DEVELOPER:	GULF BEACH SELF STORAGE, INC 3886 PARADISE BAY DRIVE GULF BREEZE, FLORIDA 32563 850-982-4411
PROPERTY REFERENCE NO:	33-2S-31-1000-002-075
PROPERTY ADDRESS:	8939 GULF BEACH HIGHWAY
PROPERTY AREA:	4.30 ACRES
PROJECT AREA:	4.30 ACRES
PROPERTY ZONING:	HC/LI, HC/LI-NA
FUTURE LAND USE:	MU-U
PROPOSED ACTIVITY:	SELF STORAGE
REQUIRED BUILDING SETBACKS C-1:	FRONT YARD - 15 FT. SIDE YARD - 10 FT. REAR YARD - 15 FT.

Approved
ESCAMBIA COUNTY DRC PLAN REVIEW

DRC Chairman Signature: *Jennifer Hampton* Date: 1-19-22

Printed Name: Jennifer Hampton
Development Services Director or Designee

This document has been reviewed in accordance with the requirements of applicable Escambia County Regulations and Ordinances, and does not in any way relieve the submitting Architect, Engineer, Surveyor or other signatory from responsibility of details as drawn. A Development Order (DO) must be obtained through the Development Review Process prior to the commencement of construction. This DO approval does not constitute approval by any other agency. All additional state/federal permits shall be provided to the county prior to approval of a final plat or the issuance of state/federal permits shall be provided to the county prior to approval of a final plat or the issuance of a building permit.



FEMA FLOOD INSURANCE RATE MAP

THE PARCEL SHOWN FOR DEVELOPMENT IS LOCATED WITHIN THE FLOOD ZONE(S) AS DETAILED BY FEMA FIRM (FLOOD INSURANCE RATE MAP) INFORMATION.

FLOOD ZONE(S)	COMMUNITY No.	MAP No.	PANEL No.	SUR
X	120080	12033C	0527	C

CONTACTS

ENGINEER OF RECORD REBOL-BATTLE & ASSOCIATES 2301 N 9TH AVE PENSACOLA, FLORIDA 32503	CONTACT: PAUL BATTLE PHONE: 850.428.0400 (O) 850.554.2406 (C) EMAIL: PAULB@REBOL-BATTLE.COM
SURVEYOR OF RECORD REBOL-BATTLE & ASSOCIATES 2301 N 9TH AVE PENSACOLA, FLORIDA 32503	CONTACT: MARK A. NORRIS, P.S.M. PHONE: 850.428.0400 EMAIL: MARK@REBOL-BATTLE.COM
ESCAMBIA COUNTY PUBLIC WORKS 3363 WEST PARK PLACE PENSACOLA, FLORIDA 32501	CONTACT: MRS. JOHNNY PETTIGREW PHONE: 850.595.3404
GULF POWER 5120 DOGWOOD DRIVE MILTON, FLORIDA 32570	CONTACT: CHAD SWAILS PHONE: 850.429.2446
AT&T, INC. 605 W. GARDEN STREET PENSACOLA, FLORIDA 32501	CONTACT: JONATHAN BLACKINGHIP PHONE: 850.436.1489
ECUA 9255 STURDEVANT STREET PENSACOLA, FLORIDA 32514	CONTACT: TOMMY TAYLOR PHONE: 850.969.6516
COX CABLE 3405 MCLEMORE DRIVE PENSACOLA, FLORIDA 32514	CONTACT: TROY YOUNG PHONE: 850.857.4510
ENERGY SERVICES GAS 1625 ATWOOD DRIVE PENSACOLA, FLORIDA 32504	CONTACT: DIANE MOORE PHONE: 850.474.5319
MCI	PHONE: 800.624.9675
SUNSHINE UTILITIES	PHONE: 800.432.4770

VICINITY MAP
SCALE: 1" = 500'



REBOL-BATTLE & ASSOCIATES
Civil Engineers and Surveyors

2301 N. Ninth Avenue, Suite 300
Pensacola, Florida 32503
Telephone 850.438.0400
Fax 850.438.0448
EB 00009657 LB 7916

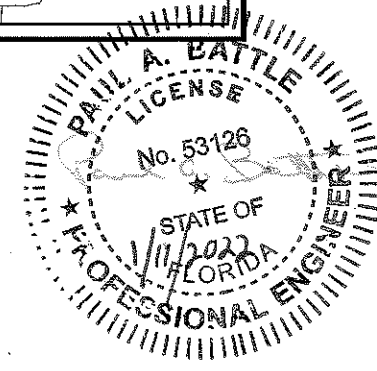

INDEX OF DRAWINGS

- C1.0 EXISTING SITE, DEMOLITION AND EROSION CONTROL PLAN
- C1.1 EROSION CONTROL DETAILS
- C1.2 NPDES-STORMWATER POLLUTION PREVENTION PLAN
- C2.0 SITE LAYOUT AND DIMENSION PLAN
- C2.1 SITE DETAILS
- C3.0 GRADING AND DRAINAGE PLAN
- C3.1 GRADING AND DRAINAGE DETAILS
- C4.0 UTILITY PLAN
- C4.1 UTILITY DETAILS
- C4.2 LIFT STATION DETAILS
- C5.0 LANDSCAPE & STRIPING PLAN
- C5.1 LANDSCAPE & STRIPING DETAILS

LEGAL DESCRIPTION

DESCRIPTION: (OFFICIAL RECORDS BOOK 7695 AT PAGE 1880)

EAST-HALF OF LOT 76, BEYREUTH SUBDIVISION, SECTION 33/4, TOWNSHIP 2/3 SOUTH, RANGE 31 WEST, DESCRIBED ACCORDING TO PLAT OF SAID SUBDIVISION RECORDED IN DEED BOOK 74, PAGE 100 OF THE PUBLIC RECORDS OF ESCAMBIA COUNTY, FLORIDA, AND ADJACENT 1/2 OF VACATED 6TH AVENUE.

LESS AND EXCEPT

THAT PORTION OF THE EAST 1/2 OF LOT 76, BEYREUTH SUBDIVISION, SECTION 33/4, TOWNSHIP 2/3 SOUTH, RANGE 31 WEST, DESCRIBED ACCORDING TO PLAT OF SAID SUBDIVISION, AS RECORDED IN DEED BOOK 74, AT PAGE 100, OF THE PUBLIC RECORDS OF ESCAMBIA COUNTY, FLORIDA, TOGETHER WITH ADJACENT 1/2 OF VACATED 6TH AVENUE, BEING DESCRIBED AS FOLLOWS:

COMMENCE AT THE NORTHEAST CORNER OF THE EAST 1/2 OF LOT 76, BEYREUTH SUBDIVISION, BEING A PORTION OF SECTIONS 33 AND 4, TOWNSHIPS 2 AND 3 SOUTH, RANGE 31 WEST, ESCAMBIA COUNTY, FLORIDA ACCORDING TO THE PLAT THEREOF RECORDED IN DEED BOOK 74, PAGE 100, OF THE PUBLIC RECORDS OF SAID ESCAMBIA COUNTY, SAID POINT BEING ON THE SOUTH RIGHT-OF-WAY LINE OF GULF BEACH HIGHWAY (66.00 FOOT RIGHT-OF-WAY); THENCE GO NORTH 89 DEGREES 57 MINUTES 01 SECONDS WEST ALONG SAID SOUTH RIGHT-OF-WAY LINE A DISTANCE OF 23.76 FEET TO THE POINT OF BEGINNING; THENCE DEPARTING SAID RIGHT-OF-WAY LINE, GO SOUTH 00 DEGREES 00 MINUTES 00 SECONDS WEST, A DISTANCE OF 228.93 FEET, THENCE GO NORTH 88 DEGREES 01 MINUTES 14 SECONDS WEST, A DISTANCE OF 126.32 FEET, THENCE GO NORTH 00 DEGREES 00 MINUTES 00 SECONDS EAST, A DISTANCE OF 274.68 FEET TO THE AFORESAID SOUTH RIGHT-OF-WAY LINE OF GULF BEACH HIGHWAY, THENCE GO SOUTH 89 DEGREES 57 MINUTES 01 SECONDS EAST ALONG SAID SOUTH RIGHT-OF-WAY LINE, A DISTANCE OF 126.24 FEET TO THE POINT OF BEGINNING.

AND ALSO

THE WEST 120 FEET OF LOT 75, BEYREUTH, A SUBDIVISION OF SECTIONS 33/4, TOWNSHIPS 2/3 SOUTH, RANGE 31 WEST, ESCAMBIA COUNTY, FLORIDA, ACCORDING TO PLAT OF SAID SUBDIVISION RECORDED IN DEED BOOK 74, AT PAGE 100 OF THE PUBLIC RECORDS OF SAID COUNTY, AND ADJACENT 1/2 OF VACATED 6TH AVENUE.

THE CONTRACTOR IS RESPONSIBLE FOR OBTAINING "RELEASED FOR CONSTRUCTION" DRAWINGS FROM REBOL-BATTLE & ASSOCIATES BEFORE BEGINNING CONSTRUCTION. REBOL-BATTLE & ASSOCIATES WILL NOT BE RESPONSIBLE FOR ANY CONSTRUCTION BASED ON PLANS THAT HAVE NOT BEEN RELEASED FOR CONSTRUCTION.

**EXISTING SITE, DEMOLITION
 & EROSION CONTROL PLAN**

**GULF BEACH
 SELF STORAGE
 8939 GULF BEACH HIGHWAY
 ESCAMBIA COUNTY, FLORIDA**

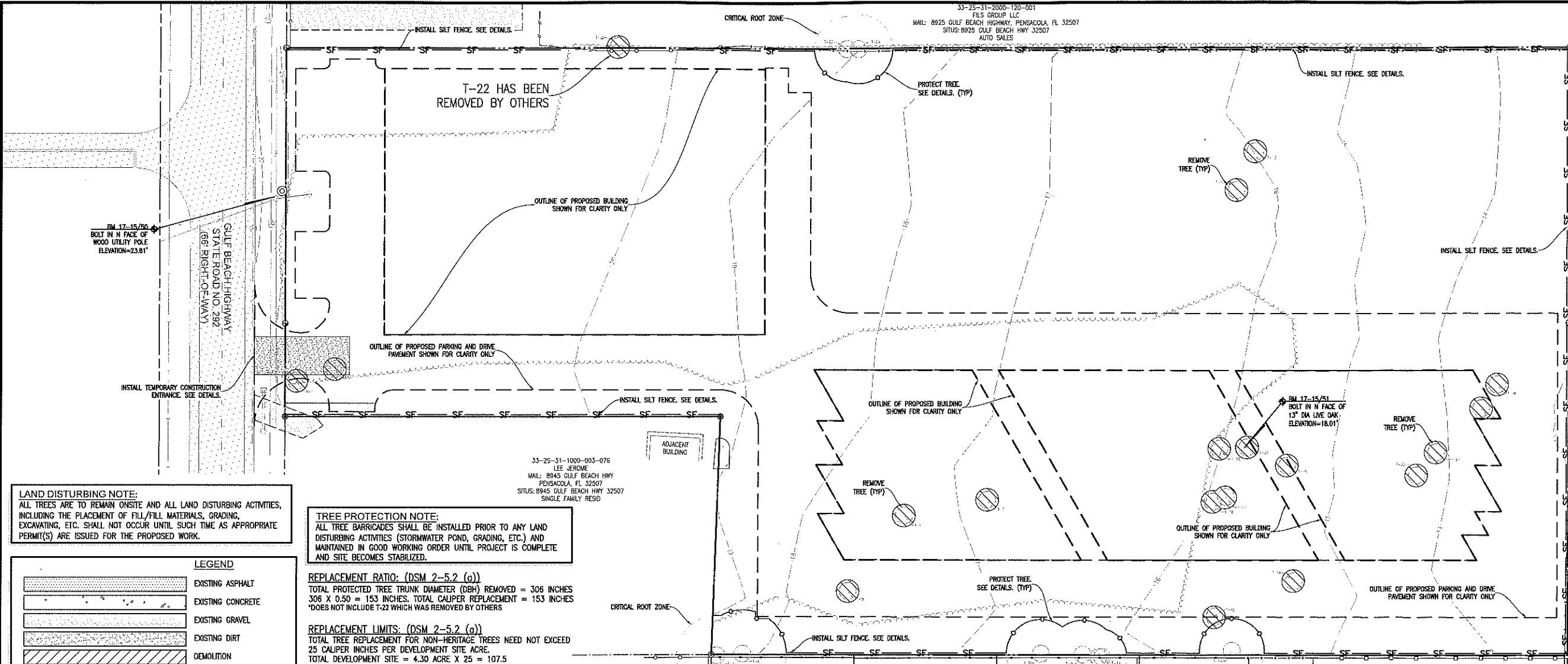

LAND DISTURBING NOTE:
 ALL TREES ARE TO REMAIN ONSITE AND ALL LAND DISTURBING ACTIVITIES, INCLUDING THE PLACEMENT OF FILL/FILL MATERIALS, GRADING, EXCAVATING, ETC. SHALL NOT OCCUR UNTIL SUCH TIME AS APPROPRIATE PERMIT(S) ARE ISSUED FOR THE PROPOSED WORK.

TREE PROTECTION NOTE:
 ALL TREE BARRICADES SHALL BE INSTALLED PRIOR TO ANY LAND DISTURBING ACTIVITIES (STORMWATER POND, GRADING, ETC.) AND MAINTAINED IN GOOD WORKING ORDER UNTIL PROJECT IS COMPLETE AND SITE BECOMES STABILIZED.

REPLACEMENT RATIO: (DSM 2-5.2 (a))
 TOTAL PROTECTED TREE TRUNK DIAMETER (DBH) REMOVED = 306 INCHES
 306 X 0.50 = 153 INCHES. TOTAL CALIPER REPLACEMENT = 153 INCHES
 *DOES NOT INCLUDE T-22 WHICH WAS REMOVED BY OTHERS

REPLACEMENT LIMITS: (DSM 2-5.2 (a))
 TOTAL TREE REPLACEMENT FOR NON-HERITAGE TREES NEED NOT EXCEED 25 CALIPER INCHES PER DEVELOPMENT SITE ACRE.
 TOTAL DEVELOPMENT SITE = 4.30 ACRE X 25 = 107.5
 REPLACEMENT LIMITS = 108 INCHES

REQUIRED TOTAL CALIPER REPLACEMENT = 108 INCHES
 TOTAL 2.5 INCH TREES REQUIRED = 43
 CALIPER INCHES ARE TO BE REPLACED/PLANTED USING A MINIMUM 2.5 CALIPER INCH NATIVE CANOPY, FL GRADE 1 OR BETTER
 REPLACEMENT/MITIGATION TREE:
 THE DEVELOPER CHOOSES TO PAY INTO THE ESCAMBIA COUNTY TREE FUND.
 43 TREES X \$350.00 PER TREE = \$15,050.00

GENERAL NOTES:
 1. ALL WORK SHALL BE PERFORMED IN ACCORDANCE WITH THESE PLANS AND SPECIFICATIONS AND THE REQUIREMENTS AND STANDARDS OF ALL GOVERNING AUTHORITIES.

2. PRIOR TO STARTING CONSTRUCTION, THE CONTRACTOR SHALL BE RESPONSIBLE FOR CONFIRMING THAT ALL REQUIRED PERMITS AND APPROVALS HAVE BEEN OBTAINED. NO CONSTRUCTION OR FABRICATION SHALL BEGIN UNTIL THE CONTRACTOR HAS RECEIVED AND THOROUGHLY REVIEWED ALL PLANS AND OTHER DOCUMENTS APPROVED BY ALL OF THE PERMITTING AGENCIES.

3. THE LOCATION OF UNDERGROUND FACILITIES SHOWN ON THESE PLANS IS BASED ON INFORMATION PROVIDED BY THE UTILITIES AND SHALL BE CONSIDERED APPROXIMATE. IT SHALL BE THE CONTRACTOR'S FULL RESPONSIBILITY TO CONTACT THE VARIOUS UTILITY COMPANIES TO LOCATE THEIR FACILITIES PRIOR TO STARTING CONSTRUCTION. NO ADDITIONAL COMPENSATION SHALL BE PAID TO THE CONTRACTOR FOR DAMAGE AND REPAIR TO THESE FACILITIES CAUSED BY HIS WORK FORCE.

4. THE CONTRACTOR SHALL NOTIFY THE SUPERINTENDENTS OF THE WATER, SANITARY SEWER, GAS, TELEPHONE, CABLE TELEVISION, AND POWER COMPANIES 10 DAYS IN ADVANCE THAT HE INTENDS TO START WORK IN A SPECIFIED AREA. THE OWNER DISCLAIMS ANY RESPONSIBILITY FOR THE SUPPORT AND PROTECTION OF SEWERS, DRAINS, WATER PIPES, GAS PIPES, CONDUITS OF ANY KIND, UTILITIES OR OTHER STRUCTURES OWNED BY THE CITY, COUNTY, STATE OR BY PRIVATE OR PUBLIC UTILITIES LEGALLY OCCUPYING ANY STREET, ALLEY, PUBLIC PLACE OR RIGHT-OF-WAY.

5. ALL SITE CLEARING SHALL INCLUDE THE LOCATION AND REMOVAL OF ALL UNDERGROUND STRUCTURES, WHICH ARE NOT IN SERVICE AS NECESSARY FOR THE INSTALLATION OF PROPOSED IMPROVEMENTS. THESE INCLUDE PIPES, VALVES, DRAINAGE STRUCTURES, ETC., AS INDICATED ON THE CONTRACT PLANS. CONTRACTOR SHALL NOTIFY THE PROJECT OWNER AND ENGINEER OF ALL DISCOVERED UNDERGROUND STRUCTURES WHICH ARE IN CONFLICT WITH THE INSTALLATION OF THE PROPOSED IMPROVEMENTS AND ARE NOT INDICATED ON THE CONTRACT PLANS OR LOCATED IN THE FIELD BY UTILITIES IN ACCORDANCE WITH GENERAL NOTES.

6. THE RELOCATION OF OBSTRUCTIONS OWNED BY PRIVATE PROPERTY OWNERS, SUCH AS MAIL BOXES, SHALL BE THE RESPONSIBILITY OF THE CONTRACTOR WHO MUST COORDINATE WITH THE PROPERTY OWNER.

7. THE CONTRACTOR SHALL PLACE AND MAINTAIN ADEQUATE BARRICADES, CONSTRUCTION SIGNS, FLASHING LIGHTS, TORCHES, RED LANTERNS AND GUARDS DURING ALL PHASES OF CONSTRUCTION, IN ACCORDANCE WITH APPLICABLE FDOT INDEX.

8. ALL AREAS NOT PAVED OR DISTURBED DURING CONSTRUCTION SHALL BE STABILIZED BY SEEDING AND MULCHING OR SODDING. SEED AND MULCH OR SOD SHALL BE PLACED, WATERED, FERTILIZED WITH APPROPRIATE SOIL AMENDMENTS IN ACCORDANCE WITH THE FDOT STANDARD SPECIFICATIONS AND THESE CONSTRUCTION DOCUMENTS.

9. ALL EXCESS MATERIAL SHALL BE HAULED AWAY AND DISPOSED OF APPROPRIATELY AT THE CONTRACTOR'S EXPENSE.

10. THE CONTRACTOR SHALL VISIT THE SITE TO FAMILIARIZE HIMSELF WITH EXISTING CONDITIONS AND THE EXTENT OF CLEARING AND GRUBBING REQUIRED.

11. ALL DIMENSIONS AND GRADES SHOWN ON THE PLANS SHALL BE FIELD VERIFIED BY THE CONTRACTOR PRIOR TO CONSTRUCTION. THE CONTRACTOR SHALL NOTIFY THE ENGINEER IF ANY DISCREPANCIES EXIST PRIOR TO PROCEEDING WITH CONSTRUCTION FOR NECESSARY PLAN OR GRADE CHANGES. NO EXTRA COMPENSATION SHALL BE PAID TO THE CONTRACTOR FOR WORK HAVING TO BE REDONE DUE TO DIMENSIONS OR GRADES SHOWN INCORRECTLY ON THESE PLANS IF SUCH NOTIFICATION HAS NOT BEEN GIVEN.

12. THE CONTRACTOR IS TO COORDINATE WITH THE RESPONSIBLE UTILITY PROVIDER FOR PROTECTION/HOLDING OF UTILITY POLES, GUY WIRES, AND GUY ANCHORS IN AREAS OF CONSTRUCTION. THE CONTRACTOR SHALL INCLUDE THE COST OF PROTECTING UTILITY POLES IN THEIR OVERALL PRICE TO THE OWNER.

13. ANY DAMAGE TO EXISTING ROADS DURING CONSTRUCTION SHALL BE REPAIRED BY THE CONTRACTOR PRIOR TO FINAL "AS-BUILT" SIGN-OFF FROM THE COUNTY.

14. THE OPERATION AND MAINTENANCE OF THE FACILITY WILL BE THE RESPONSIBILITY OF THE OWNER, AS IN ACCORDANCE WITH THE APPROVED PERMIT.

15. THE CONTRACTOR SHALL NOTIFY FDOT 48 HOURS IN ADVANCE PRIOR TO INITIATING ANY WORK IN THE STATE RIGHTS-OF-WAY.

16. HAY BALES SHALL NOT BE PERMITTED WITHIN THE RIGHT-OF-WAY. ONLY SYNTHETIC BALES MAY BE USED.

17. THE PROJECT ENGINEER (ENGINEER OF RECORD) SHALL PROVIDE ESCAMBIA COUNTY "AS-BUILT" RECORD DRAWINGS FOR VERIFICATION AND APPROVAL BY ESCAMBIA COUNTY ONE WEEK PRIOR TO REQUESTING A FINAL INSPECTION AND CERTIFICATE OF OCCUPANCY, OR PROVIDE "AS-BUILT" CERTIFICATION THAT THE PROJECT CONSTRUCTION ADHERES TO THE PERMITTED PLANS AND SPECIFICATIONS. THE "AS-BUILT" CERTIFICATION OR THE "AS-BUILT" RECORD DRAWINGS MUST BE SIGNED, SEALED AND DATED BY A REGISTERED FLORIDA PROFESSIONAL ENGINEER.

18. THE OWNER OR HIS AGENT SHALL ARRANGE/SCHEDULE WITH THE COUNTY A FINAL INSPECTION OF THE DEVELOPMENT UPON COMPLETION AND ANY INTERMEDIATE INSPECTIONS AT (850)595-3472. AS-BUILT CERTIFICATION IS REQUIRED PRIOR TO REQUEST FOR FINAL INSPECTION/APPROVAL.

LEGEND

[Pattern]	EXISTING ASPHALT
[Pattern]	EXISTING CONCRETE
[Pattern]	EXISTING GRAVEL
[Pattern]	EXISTING DIRT
[Pattern]	DEMOLITION
[Pattern]	RIPRAP
[Line]	BOUNDARY LINE
[Line]	EASEMENT LINE
[Line]	LOT LINE
[Line]	RIGHT-OF-WAY LINE
[Line]	ACOE LINE
[Line]	FDOP LINE
[Line]	WETLAND LINE
[Line]	WATER LINE
[Line]	SEWER LINE (GRAVITY)
[Line]	FORCE MAIN
[Line]	OVERHEAD UTILITIES
[Line]	BURIED TELEPHONE LINE
[Line]	GAS LINE
[Line]	BURIED ELECTRIC LINE
[Line]	BURIED FIBER OPTIC CABLE
[Line]	BURIED TV LINE
[Line]	EXISTING CONTOUR
[Line]	STRAW BALE
[Line]	SILT FENCE
[Line]	TREE BARRICADE
[Symbol]	UTILITY POLE
[Symbol]	BENCHMARK
[Symbol]	LIGHT POLE
[Symbol]	FIRE HYDRANT
[Symbol]	TELEPHONE BOX
[Symbol]	WATER METER
[Symbol]	GAS VALVE
[Symbol]	WATER VALVE
[Symbol]	MAILBOX
[Symbol]	CLEANOUT
[Symbol]	POST
[Symbol]	MANHOLE
[Symbol]	STREET SIGN
[Symbol]	GUY ANCHOR
[Symbol]	SIGN

TREE CHART

TREE #	SIZE & TYPE	PROTECT/REMOVE
T-1	19" DIA PECAN	REMOVE
T-2	14" DIA LIVE OAK	REMOVE
T-3	21" DIA LIVE OAK	PROTECT
T-4	23" DIA MAGNOLIA	PROTECT
T-5	12" DIA PECAN	REMOVE
T-6	12" DIA LIVE OAK	REMOVE
T-7	12" DIA LAURAL OAK & 12" DIA CEDAR	REMOVE
T-8	18" DIA LIVE OAK	PROTECT
T-9	18" DIA LIVE OAK	PROTECT
T-10	15" DIA LIVE OAK	PROTECT
T-11	13" DIA LIVE OAK	PROTECT
T-12	30" DIA LIVE OAK	REMOVE
T-13	18" DIA LIVE OAK	REMOVE
T-14	17" DIA LAURAL OAK	PROTECT

TREE CHART

TREE #	SIZE & TYPE	PROTECT/REMOVE
T-15	26" DIA LIVE OAK	REMOVE
T-16	12" DIA LIVE OAK	REMOVE
T-17	13" DIA LIVE OAK	REMOVE
T-18	26" DIA LIVE OAK	REMOVE
T-19	16" DIA LAURAL OAK	REMOVE
T-20	21" DIA LIVE OAK	REMOVE
T-21	13" DIA LIVE OAK	REMOVE
T-22	31" DIA LIVE OAK	REMOVED BY OTHERS
T-23	17" DIA LAURAL OAK	PROTECT
T-24	19" DIA LAURAL OAK	PROTECT
T-25	12" DIA LIVE OAK	REMOVE
T-26	13" DIA LIVE OAK	REMOVE
T-27	13" DIA LIVE OAK	REMOVE
T-28	12" DIA LIVE OAK	REMOVE

NO HERITAGE OR CHAMPION TREES ARE LOCATED ON-SITE.

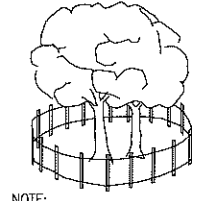

**TREE BARRICADE
 DETAIL**
 N.T.S.

NOTE:
 ALL PROTECTED TREES AS SHOWN ON THE PLANS TO REMAIN ARE TO BE PROTECTED DURING CONSTRUCTION. THE CONTRACTOR SHALL INSTALL ORANGE CONSTRUCTION FENCING AT THE DRIP LINE OF EACH PROTECTED TREE BEFORE WORKING IN THE VICINITY OF THE TREE.

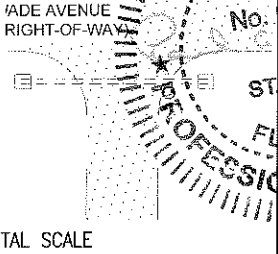
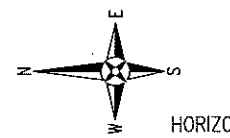

DATE: 06/15/2021
 DRAWING No. C1.0

GENERAL NOTES FOR SOIL EROSION AND SEDIMENT CONTROL:

1. ALL EROSION AND SEDIMENT CONTROL PRACTICES TO BE INSTALLED PRIOR TO ANY MAJOR SOIL DISTURBANCE, OR IN THEIR PROPER SEQUENCE, AND MAINTAINED UNTIL PERMANENT PROTECTION IS ESTABLISHED.
2. ANY DISTURBED AREAS THAT WILL BE LEFT EXPOSED MORE THAN 30 DAYS, AND NOT SUBJECT TO CONSTRUCTION TRAFFIC, WILL IMMEDIATELY RECEIVE A TEMPORARY SEEDING. IF THE SEASON PREVENTS THE ESTABLISHMENT OF A TEMPORARY COVER, THE DISTURBED AREAS WILL BE MULCHED WITH STRAW, OR EQUIVALENT MATERIAL, AT A RATE OF TWO (2) TONS PER ACRE, ACCORDING TO STATE STANDARDS.
3. PERMANENT VEGETATION TO BE SEEDING OR SOODED ON ALL EXPOSED AREAS WITHIN TEN (10) DAYS AFTER GRADING. MULCH TO BE USED AS NECESSARY FOR PROTECTION UNTIL SEEDING IS ESTABLISHED.
4. ALL WORK AND MATERIALS TO BE IN ACCORDANCE WITH THE FDOT "STANDARD SPECIFICATIONS FOR ROAD AND BRIDGE CONSTRUCTION", LATEST EDITION, SECTIONS 104, 570, 981, 982, 983, 985, & 987.
5. A BITUMINOUS CONCRETE BASE COURSE WILL BE APPLIED IMMEDIATELY FOLLOWING ROUGH GRADING AND INSTALLATION OF IMPROVEMENTS IN ORDER TO STABILIZE STREETS, ROADS, DRIVEWAYS AND PARKING AREAS. IN AREAS WHERE NO UTILITIES ARE PRESENT, THE BITUMINOUS CONCRETE BASE SHALL BE INSTALLED WITHIN 15 DAYS OF THE PRELIMINARY GRADING.
6. IMMEDIATELY FOLLOWING INITIAL DISTURBANCE OR ROUGH GRADING, ALL CRITICAL AREAS SUBJECT TO EROSION (I.E. STEEP SLOPES AND ROADWAY EMBANKMENTS) WILL RECEIVE A TEMPORARY SEEDING IN COMBINATION WITH STRAW MULCH OR A SUITABLE EQUIVALENT, AT A THICKNESS OF TWO (2) TO FOUR (4) INCHES MIXED WITH THE TOP TWO (2) INCHES OF SOIL, ACCORDING TO STATE STANDARDS.
7. ANY STEEP SLOPES RECEIVING PIPELINE INSTALLATION WILL BE BACKFILLED AND STABILIZED DAILY, AS THE INSTALLATION PROCEEDS (I.E. SLOPES GREATER THAN 3:1).
8. A CRUSHED LIMEROCK, VEHICLE WHEEL-CLEANING BLANKET SHALL BE INSTALLED AT THE CONTRACTOR'S STAGING YARD AND/OR STOCKPILE AREAS TO PREVENT OFF-SITE TRACKING OF SEDIMENT BY CONSTRUCTION VEHICLES ONTO PUBLIC ROADS. BLANKET SHALL BE 15FT. X 50FT. X 6IN. (MINIMUM), CRUSHED LIMEROCK 2 1/2 INCHES IN DIAMETER, SAID BLANKET SHALL BE UNDERLAIN WITH A FDOT CLASS 3 SYNTHETIC FILTER FABRIC AND MAINTAINED IN GOOD ORDER.
9. AT THE TIME WHEN THE SITE PREPARATION FOR PERMANENT VEGETATIVE STABILIZATION IS GOING TO BE ACCOMPLISHED, ANY SOIL THAT WILL NOT PROVIDE A SUITABLE ENVIRONMENT TO SUPPORT ADEQUATE VEGETATIVE GROUND COVER, SHALL BE REMOVED OR TREATED IN SUCH A WAY THAT WILL PERMANENTLY ALTER THE SOIL CONDITIONS AND RENDER IT SUITABLE FOR VEGETATIVE GROUND COVER. IF THE REMOVAL OR TREATMENT OF THE SOIL WILL NOT PROVIDE SUITABLE CONDITIONS, NON-VEGETATIVE MEANS OF PERMANENT GROUND STABILIZATION WILL HAVE TO BE EMPLOYED.
10. CONDUIT OUTLET PROTECTION MUST BE INSTALLED AT ALL REQUIRED OUTFALLS PRIOR TO THE DRAINAGE SYSTEM BECOMING OPERATIONAL.
11. UNFILTERED DEWATERING IS NOT PERMITTED. THE CONTRACTOR SHALL TAKE ALL NECESSARY PRECAUTIONS DURING ALL DEWATERING OPERATIONS TO MINIMIZE SEDIMENT TRANSFER.
12. SHOULD THE CONTROL OF DUST AT THE SITE BE NECESSARY, THE SITE WILL BE SPRINKLED UNTIL THE SURFACE IS WET, TEMPORARY VEGETATION COVER SHALL BE ESTABLISHED OR MULCH SHALL BE APPLIED IN ACCORDANCE WITH STATE STANDARDS FOR EROSION CONTROL.
13. ALL SOIL WASHED, DROPPED, SPILLED OR TRACKED OUTSIDE THE LIMIT OF DISTURBANCE OR ONTO PUBLIC RIGHTS-OF-WAY WILL BE REMOVED IMMEDIATELY.
14. THE CONTRACTOR SHALL BE RESPONSIBLE FOR ANY EROSION OR SEDIMENTATION THAT MAY OCCUR BELOW STORMWATER OUTFALLS OR OFFSITE AS A RESULT OF CONSTRUCTION OF THE PROJECT.
15. ALL SOIL STOCKPILES ARE TO BE TEMPORARILY STABILIZED IN ACCORDANCE WITH SOIL EROSION AND SEDIMENT CONTROL NOTE NUMBER 2 (ABOVE).
16. THE SITE SHALL AT ALL TIMES BE GRADED AND MAINTAINED SUCH THAT ALL STORM WATER RUNOFF IS DIVERTED TO SOIL EROSION AND SEDIMENT CONTROL FACILITIES.
17. ALL SEDIMENTATION STRUCTURES SHALL BE INSPECTED AND MAINTAINED REGULARLY.
18. ALL CATCH BASIN INLETS SHALL BE PROTECTED WITH HAY BALES AS SHOWN ON DETAIL.
19. THE CONTRACTOR SHALL PREPARE A PLAN FOR THE PROPER DEWATERING AND DOWNSTREAM SILTATION PROTECTION OF EACH STREAM CROSSING PRIOR TO EXCAVATING THE STREAM BED. PLAN SHALL BE FORWARDED TO THE ENGINEER FOR APPROVAL. THE ENGINEER SHALL BE NOTIFIED FOR INSPECTION PRIOR TO EACH STREAM CROSSING CONSTRUCTION.
20. ANY AREAS USED FOR THE CONTRACTOR'S STAGING, INCLUDING BUT NOT LIMITED TO, TEMPORARY STORAGE OF STOCKPILED MATERIALS (E.G. CRUSHED STONE, QUARRY PROCESS STONE, SELECT FILL, EXCAVATED MATERIALS, ETC.), SHALL BE ENTIRELY PROTECTED BY A SILT FENCE ALONG THE LOW ELEVATION SIDE TO CONTROL SEDIMENT RUNOFF.

* WHERE APPLICABLE

TEMPORARY SEEDING DETAILS:

SEED BED PREPARATION:

SOIL TO BE THOROUGHLY PULVERIZED BY DISK-HARROWING AND BE LOOSE AND REASONABLY SMOOTH. APPLY FERTILIZER AT A RATE OF 250 LBS/ACRE OF 15-16-16 OR EQUIVALENT, APPLY DOLOMITIC LIMESTONE AT A RATE OF 800 TO 1000 LBS/ACRE TO PROVIDE A SOIL PH OF 5.5 TO 6.5, LIME & FERTILIZER TO BE WORKED INTO THE TOPSOIL TO A DEPTH OF 4". ADD SANDY LOAM TOPSOIL TO A MINIMUM OF TWO (2) INCHES WHERE REQUIRED.

SEED MIXTURE:

CONSISTING OF ANNUAL RYE (LOLIUM MULTIFLORUM) AT A RATE OF 174 LBS/ACRE.

PERMANENT SEEDING DETAILS:

SEED BED PREPARATION:

SOIL TO BE THOROUGHLY PULVERIZED BY DISK-HARROWING AND BE LOOSE AND REASONABLY SMOOTH. APPLY FERTILIZER AT A RATE OF 250 LBS/ACRE OF 15-16-16 OR EQUIVALENT, APPLY DOLOMITIC LIMESTONE AT A RATE OF 800 TO 1000 LBS/ACRE TO PROVIDE A SOIL PH OF 5.5 TO 6.5, LIME & FERTILIZER TO BE WORKED INTO THE TOPSOIL TO A DEPTH OF 4". ADD SANDY LOAM TOPSOIL TO A MINIMUM OF TWO (2) INCHES WHERE REQUIRED.

SEED MIXTURE CONSISTING OF:

SEED MIXTURE CONSISTING OF	RATE	PURITY	GERMINATION
ARGENTINE BAHIA	250 LBS/AC.	95%	90%
PENSACOLA BAHIA	250 LBS/AC.	95%	40%(MIN.)-80%(TOTAL)

SODDING:

SOD SHALL BE WELL ROOT MATTED CENTIPEDE OR BAHIA GRASS COMMERCIALY CUT TO A MINIMUM DIMENSION OF 12" X 24" A MAXIMUM OF 72 HOURS PRIOR TO PLACEMENT. SOD SHALL BE LIVE, FRESH AND UNINJURED, REASONABLY FREE OF WEEDS AND OTHER GRASSES, WITH A HEAVY SOIL MAT ADHERING TO THE ROOT SYSTEM. SOD SHALL BE GROWN, CUT, AND SUPPLIED BY A STATE CERTIFIED GROWER.

TRAFFIC CONTROL STANDARDS:

1. CONSTRUCTION TRAFFIC SHALL BE RESTRICTED TO ONSITE ACCESS BY MEANS SO DESIGNATED BY THE ENGINEER, POLICE/SHERIFF DEPARTMENT, ESCAMBIA COUNTY HIGHWAY DEPARTMENT, AND/OR THE FLORIDA DEPARTMENT OF TRANSPORTATION.
2. TRAFFIC DURING WET WEATHER SHALL BE MINIMIZED AND APPROPRIATE ROADWAY AND SITE CLEAN-UP SHALL BE PROVIDED BY THE CONTRACTOR AS SOON AS WEATHER CONDITIONS PERMIT.

TREE PROTECTION:

1. DAMAGED TRUNKS OR EXPOSED ROOTS WILL BE PAINTED IMMEDIATELY WITH A GOOD GRADE OF "TREE PAINT".
2. TREE LIMB REMOVAL, WHERE NECESSARY, WILL BE DONE FLUSH TO TRUNK OR MAIN BRANCH AND THAT AREA PAINTED IMMEDIATELY WITH A GOOD GRADE OF TREE PAINT.

DUST CONTROL:

1. ALL AREAS OF CLEARING AND EMBANKMENT AS WELL AS CONSTRUCTION HAUL ROADS SHALL BE TREATED AND MAINTAINED IN SUCH A MANNER AS TO MINIMIZE ANY DUST GENERATION.
2. DISTURBED AREAS SHALL BE MAINTAINED IN A ROUGH GRADED CONDITION AND TEMPORARILY SEEDING AND/OR MULCHED UNTIL PROPER WEATHER CONDITIONS EXIST FOR THE ESTABLISHMENT OF PERMANENT VEGETATION COVER.
3. IN EVENT OF EMERGENCY CONDITIONS, TILLAGE WILL BE SATISFACTORY FREE BEFORE SOIL BLOWING STARTS.
4. CALCIUM CHLORIDE MAY BE APPLIED TO UNPAVED ROADWAY AREAS, ONLY, SUBJECT TO THE ENGINEER'S APPROVAL AND CONFORMANCE WITH FDOT STANDARD SPECIFICATIONS, SECTION 104, LATEST EDITION.

PROPOSED SEQUENCE OF CONSTRUCTION:

1. THE INSTALLATION OF ALL SEDIMENT AND EROSION CONTROL DEVICES THAT CAN BE PLACED PRIOR TO ANY MAJOR SOIL DISTURBANCES.
2. CLEAR AND REMOVE ALL EXISTING VEGETATION IN THOSE AREAS WHERE NECESSARY. ALL REMAINING VEGETATION IS TO BE PROPERLY PROTECTED AND IS TO REMAIN IN ITS NATURAL STATE. TOPSOIL IN AREAS TO BE DISTURBED IS TO BE STRIPPED TO A MINIMUM DEPTH OF SIX (6) INCHES AND STOCKPILED SEPARATELY FROM OTHER EXCAVATED SOIL(S).
3. THE IMMEDIATE INSTALLATION OF ALL REMAINING SEDIMENT AND EROSION CONTROL DEVICES.
4. PERFORM ALL DEMOLITION WORK.
5. CONSTRUCT ALL UNDERGROUND UTILITIES AND STORM DRAIN SYSTEMS.
6. CONSTRUCT ROADS (SUBGRADE, CURB & GUTTER, BASE, PAVEMENT, SIDEWALKS AND LANDSCAPING).
7. COMPLETE STORMWATER PONDS.
8. UPON THE COMPLETION OF THE CONSTRUCTION ACTIVITIES, PROVIDE RESTORATION, FINE GRADE REMAINDER OF SITE, RESPRAD STOCKPILED TOPSOIL AND STABILIZE WITH PERMANENT VEGETATIVE COVER AND LANDSCAPING.
9. THE REMOVAL OF APPROPRIATE TEMPORARY SEDIMENT AND EROSION CONTROL DEVICES.

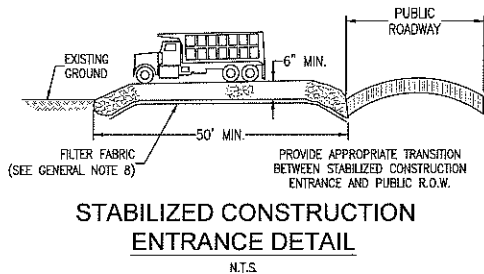

STABILIZED CONSTRUCTION ENTRANCE DETAIL
N.T.S.

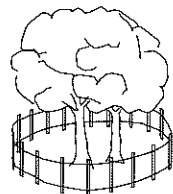

NOTE:
ALL PROTECTED TREES AS SHOWN ON THE PLANS TO REMAIN ARE TO BE PROTECTED DURING CONSTRUCTION. THE CONTRACTOR SHALL INSTALL ORANGE CONSTRUCTION FENCING AT THE DRIP LINE OF EACH PROTECTED TREE BEFORE WORKING IN THE VICINITY OF THE TREE.

TREE BARRICADE DETAIL
N.T.S.

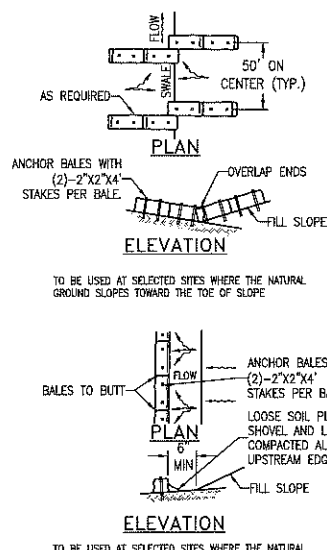

BARRIERS FOR FILL SLOPES
N.T.S.

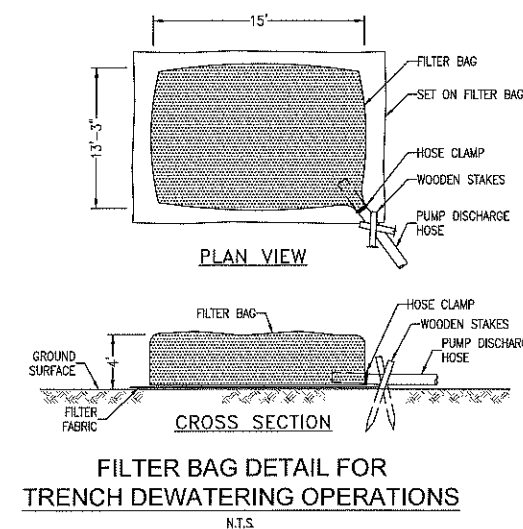

FILTER BAG DETAIL FOR TRENCH DEWATERING OPERATIONS
N.T.S.

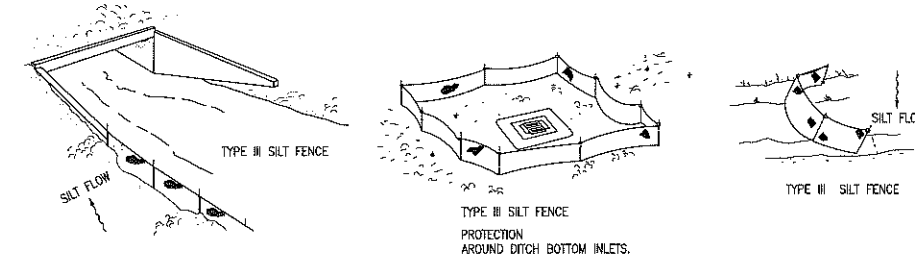

SILT FENCE APPLICATIONS
N.T.S.

DO NOT DEPLOY IN A MANNER THAT SILT FENCES WILL ACT AS A DAM ACROSS PERMANENT FLOWING WATERCOURSES. SILT FENCES ARE TO BE USED AT UPLAND LOCATIONS AND TURBIDITY BARRIERS USED AT PERMANENT BODIES OF WATER.

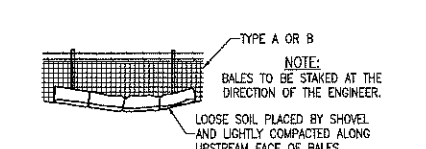

STRAW BALES BACKED BY FENCE
N.T.S.

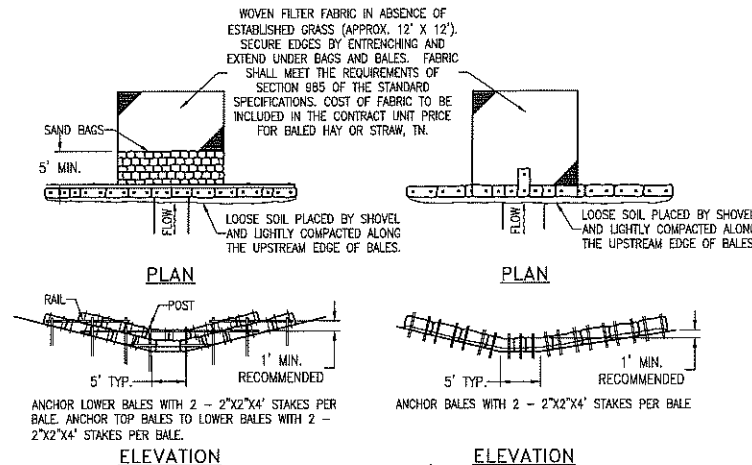

BARRIER FOR UNPAVED DITCH
N.T.S.

APPLICATION AND SPACING: THE USE OF TYPES I & II BALE BARRIERS SHOULD BE LIMITED TO THE CONDITIONS OUTLINED IN CHART 1, SHEET 1 OF 3, INDEX NO. 102

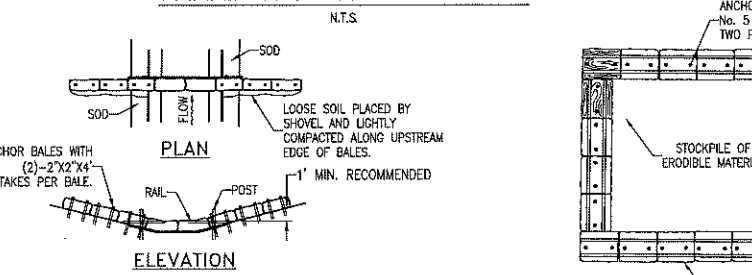

BARRIER FOR PAVED DITCH
N.T.S.

SPACING: BALE BARRIERS FOR PAVED DITCHES SHOULD BE SPACED IN ACCORDANCE WITH CHART 1, SHEET 1 OF 3, INDEX NO. 102

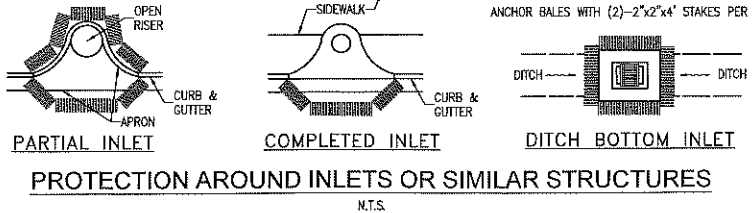

PROTECTION AROUND INLETS OR SIMILAR STRUCTURES
N.T.S.

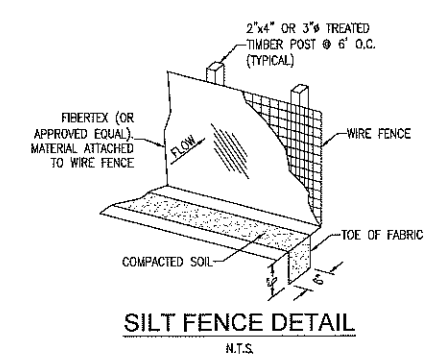

SILT FENCE DETAIL
N.T.S.

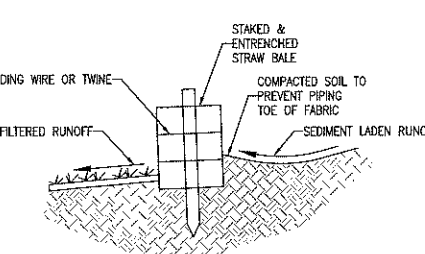

STRAW BALE DETAIL
N.T.S.

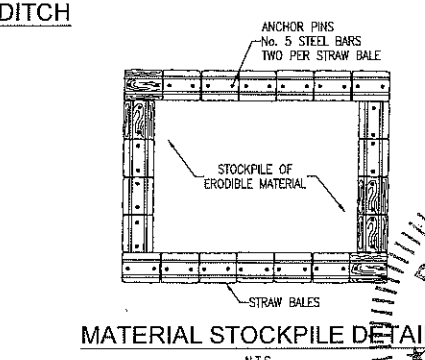

MATERIAL STOCKPILE DETAIL
N.T.S.

RBA
REBOL-BATTLE & ASSOCIATES
Civil Engineers and Surveyors
2307 N. Ninth Avenue, Suite 300
Pensacola, Florida 32503
Telephone: 904-438-0948
Fax: 904-438-0948
E-Mail: RBA@RBA.ORG

EROSION CONTROL DETAILS

GULF BEACH SELF STORAGE
8939 GULF BEACH HIGHWAY
ESCAMBIA COUNTY, FLORIDA

NO.	DATE	REVISION

PAUL A. LICHT
No. 53126
STATE OF FLORIDA
PROFESSIONAL ENGINEER
DR. PAUL BATTLE, P.E.
No. 53126
DR. BYRON BATH
ID# 1001
PAB
Job No.: 2017.285
Date: 06/15/2021
DRAWING No.
C1.1

THIS DRAWING IS THE PROPERTY OF REBOL-BATTLE & ASSOCIATES, INC. AND MUST NOT BE REPRODUCED OR TRANSMITTED IN ANY FORM OR BY ANY MEANS, ELECTRONIC OR MECHANICAL, WITHOUT WRITTEN PERMISSION.

STORM WATER POLLUTION PREVENTION PLAN

1.0 BACKGROUND & REQUIREMENTS:

1.1 Introduction:

The referenced support documentation for this Storm Water Pollution Prevention Plan (SWPPP) is the United States Environmental Protection Agency's (EPA) Storm Water Management for Construction Activities, Developing Pollution Prevention Plans and Best Management Practices Summary Guidance (EPA 833-R-92-001) and Storm Water Management for Construction Activities, Developing Pollution Prevention Plans and Best Management Practices (EPA 832-R-92-005). This SWPPP is designed to protect onsite and adjacent natural resources, including but not limited to, wetlands, marshes, bayous and bays, while preserving wildlife and archeological resources.

An Environmental Resource Permit Application has been submitted to the NWFWM June 2021

1.2 Notice of Intent (NOI):

Rule 62-621.300(4), FAC requires the construction operator of a site that disturbs one or more acres to obtain coverage from the Generic Permit for Stormwater Discharge from Large and Small Construction Activities. The contractor is required to submit a Notice of Intent to Use Generic Permit for Stormwater Discharge from Large and Small Construction Activities (FDEP Form 62-621.300(4)(b)) along with the appropriate application fee to the following address 48 hours prior to commencing construction:

NPDES Stormwater Notices Center, MS # 2510
Florida Department of Environmental Protection
2600 Blair Stone Road
Tallahassee, Florida 32399-2400

This form can be obtained from FDEP's website (www.dep.state.fl.us) or by contacting FDEP. Please note that the current application fee is \$300; however, this fee is subject to change without notice. Always refer to the most current version of Rule 62-4.050(4)(d), FAC to confirm the amount before submitting payment. If construction activity exceeds five years, the contractor must re-apply for coverage.

1.3 Stormwater Pollution Prevention Plan (SWPPP):

The contractor is required to certify this Stormwater Pollution Prevention Plan (SWPPP) below prior to submitting the NOI. This SWPPP is not required to be submitted with the NOI, but is required to be kept on site during all phases of construction. Because erosion and sediment controls and construction methods vary significantly from contractor to contractor, the contractor can propose alternative methods to this SWPPP that are equal or better at controlling erosion and sedimentation. At a minimum, the contractor must follow the erosion control plan specified in the construction plans and documents. Any modifications to this SWPPP must be documented and kept with the plan as part of the records keeping process to be in full compliance with the CGP.

1.4 Contractor's Certification:

I certify under penalty of law that this document and all attachments were prepared under my direction or supervision in accordance with a system designed to assure that qualified personnel gathered and evaluated the information submitted. Based on my inquiry of the person or persons who manage the system, or those persons directly responsible for gathering the information, the information submitted is, to the best of my knowledge and belief, true, accurate, and complete. I am aware that there are significant penalties for submitting false information, including the possibility of fine and imprisonment for knowing violations.

<u>Print & Sign Name</u>	<u>Company & Address</u>
_____	_____
<u>Name & Title (Print)</u>	_____
_____	_____
<u>Signature</u>	<u>Date</u>
_____	_____
Responsibilities (General Contractor, Site Contractor, Subcontractor, Other):	

1.5 Notice of Termination (NOT):

The contractor is required to submit a Notice of Termination of Generic Permit Coverage (FDEP Form 62-621.300(6)) upon construction completion to discontinue permit coverage. The NOT is to be submitted to the following address:

NPDES Stormwater Notices Center, MS # 2510
Florida Department of Environmental Protection
2600 Blair Stone Road
Tallahassee, Florida 32399-2400

This form can be obtained from FDEP's website (www.dep.state.fl.us) or by contacting FDEP. The NOT can not be submitted until all disturbed soils at the construction site have been finally stabilized and temporary erosion and sediment control measures have been removed or will be removed at an appropriate time. Final stabilization means that all soil disturbing activities at the site have been completed and that a uniform perennial vegetative cover with a density of 70 percent of the cover for unpaved areas and areas not covered by permanent structures has been established, or equivalent stabilization measures have been employed. If construction activity exceeds five years, the contractor must re-apply for coverage.

1.6 Application Information:

Project Address: 8939 Gulf Beach Highway
Pensacola, Florida 32504

Latitude: N 30°22'08.40"
Longitude: W 87°20'04.70"

Water Management District: Northwest Florida (NWFWM)
(APPLIED FOR)

MS4 Operator Name: Escambia County

Receiving Water Name: Eventual outfall to Bayou Grande

2.0 SITE DESCRIPTION:

2.1 Nature of Construction Activities:

This project involves the construction of a 28,000 SF commercial building and 34,400 SF of covered storage. Construction includes parking, drives, utilities, and stormwater collection system.

2.2 Sequence of Major Soil Disturbing Activities:

The following sequence of major activities shall be followed unless the contractor can propose an alternative that is equal to or better at controlling erosion and sedimentation. The detailed sequence for the entire project can vary significantly from contractor to contractor. The contractor is responsible for documenting any changes.

1. Clear, grub and perform all demolition work.
2. Complete rough grading of the pond and direct all stormwater runoff to the pond(s).
3. Construct all underground utilities and storm drain system.
4. Construct roads (subgrade, curb & gutter, base, pavement, sidewalks, and landscaping).
5. Complete stormwater ponds.

2.3 Area Estimates:

Onsite Area: 4.30 acres
Offsite Area: 0.00 acres
Total Area: 4.30 acres
Area to be Disturbed: 4.30 acres

2.4 Runoff Data:

Runoff Coefficients (c):

Before: Total Composite c = 0.20
During: Varies between 0.20 and 0.90
After: Varies between 0.20 and 0.90
Total Composite c = 0.75

Soils Data:

The soils located at the site are predominately very loose to loose slightly silty sands. Groundwater was not encountered in the 15 ft to 20 ft deep test boring. For more detailed soils information, refer to the Geotechnical Services Report prepared by Universal Engineering Services.

Drainage Areas for Each Outfall:

Outfall Location	Total Area flowing to Pond	'c' coefficient
Existing drainage swale along Wade Ave	4.30	0.75

2.5 Site Map:

The construction plans are to be used as the site maps. The location of the required information is described below. The sheet numbers for all the items discussed below are identified on the Key Sheet of the construction plans.

- **Drainage Patterns:** All drainage patterns are shown on the Grading & Drainage Plans.
- **Approximate Slopes:** Approximate slopes are shown on the Grading & Drainage Plan. Pond side slopes are shown on the pond cross-sections.
- **Areas of Soil Disturbance:** All demolition is shown on the Existing Site Conditions and Demolition and Erosion Control Plan Sheet. All proposed construction is shown on the remaining plans. Any areas where demolition work or permanent features are shown above or below ground will be disturbed.
- **Areas not to be Disturbed:** Any areas not showing demolition work or permanent features are assumed not to be disturbed. It will be the contractor's responsibility to indicate on the plans any of these areas that do get disturbed as well as any areas used for staging and materials storage.
- **Locations of Controls:** All proposed temporary controls and existing permanent controls are shown on the Existing Site, Demolition and Erosion Control Plan. All proposed permanent controls are shown on the remaining plans. It will be the contractor's responsibility to indicate the location of any other controls on the plans that are used during construction.
- **Areas to be Stabilized:** Permanent stabilization is shown on the plans. It will be the contractor's responsibility to indicate the location on the plans of all temporary stabilization practices used during construction.
- **Surface Waters:** N/A
- **Discharge Points:** Escambia County MS4

2.6 Receiving Waters:

Escambia County MS4

3.0 CONTROLS:

3.1 Erosion and Sediment Controls:

All erosion and sediment controls specified on the Demolition and Erosion Control Plan Sheets, and the Erosion Control Details shall be installed prior to any construction or demolition. Silt fencing and staked hay bales shall be installed along down-gradient limits.

Temporary seeding and mulching shall be applied after 14-day intervals of ceased disturbance activities that will exceed 20-day periods. Graded areas shall be stabilized with permanent seeding, mulching, and fertilizing, or sodding within five days of final grading. Landscaping, including sodding, shall be installed by an experienced Landscape Contractor. Proposed disturbed areas will not exceed 8 acres in any drainage area.

3.2 Stormwater Management:

Proposed stormwater management facilities for this site include:
A wet retention pond for the entire property.

The proposed stormwater management facilities meet all stormwater treatment requirements and all rate control requirements set forth by the local and state regulatory agencies.

3.3 Other Controls:

Waste Disposal: The contractor is responsible for all waste disposal from the site. The contractor shall employ waste disposal practices that meet all local, state, and federal guidelines and prevent discharge of solid materials to waters of the United States. The Contractor is responsible for documenting this portion of the SWPPP.

Offsite Vehicle Tracking: If off site tracking of sediments by construction vehicles occurs, the contractor is required to install a Soil Tracking Prevention Device (STPD) as per FDOT Standard Index 106 at all exits to the site where sediment tracking is occurring. The Contractor is also responsible for documenting this portion of the SWPPP.

4.0 MAINTENANCE:

Controls shall be kept in full operating condition throughout all phases of construction until all disturbed areas are completely stabilized. Maintenance, repair records and repair requests shall be documented. Repairs and deficiencies shall be completed as soon as possible and within seven days after inspection. Any required changes that are not covered in the SWPPP shall also be made as soon as possible within seven days and documented.

5.0 INSPECTIONS:

Qualified personnel shall inspect the following items, but not limited to, at least once every seven calendar days and within 24 hours of the end of a storm that is 0.25 inches or greater. Where sites have been finally stabilized, inspections shall be conducted at least once every month.

- Points of discharge to waters of the United States.
- Points of discharge to municipal separate storm sewer systems.
- Disturbed areas of the site that have not been finally stabilized.
- Areas used for storage of materials that are exposed to precipitation.
- Structural controls.
- Stormwater management systems.
- Locations where vehicles enter or exit the site.

6.0 NON-STORMWATER DISCHARGES:

The Contractor shall be responsible for reporting any hazardous substance spills that may equal or exceed a Reportable Quantity (RQ). Refer to EPA's List of Hazardous Substances and Reportable Quantities (EPA 40 CFR 302.4 & 117). This list can be obtained from EPA's website (www.epa.gov) or by contacting EPA. If an RQ release does occur the Contractor shall perform the following procedures:

- Notify the National Response Center immediately at 800-424-8802.
- Provide written description of the release within 14 days providing dates, cause and prevention methods to the regional EPA office.
- Modify the SWPPP as necessary to address added prevention methods.

7.0 IMPLEMENTATION CHECKLIST:

7.1 Records:

The Contractor shall maintain records of construction activities including, but not limited to:

- Dates when major grading activities occur.
- Dates when construction activities temporarily cease on a portion of the site.
- Dates when construction activities permanently cease on a portion of the site.
- Dates when stabilization measures are initiated on the site.

7.2 Inspection Reports:

The Contractor shall prepare inspection reports summarizing the following, but not limited to:

- Name of inspector.
- Qualifications of inspector.
- Measures/areas inspected.
- Observed conditions.
- Changes necessary to the SWPPP.

7.3 Releases of Reportable Quantities of Oil or Hazardous Materials:

The Contractor shall report any releases of reportable quantities of oil or hazardous materials if they occur as per the measures outlined in Section 6.0 of the SWPPP.

7.4 SWPPP Modification:

The Contractor shall modify the SWPPP as necessary to:

- Comply with minimum permit requirements when notified by FDEP that the plan does not comply.
- Address any changes in design, construction operations or maintenance, which has an effect on the potential for discharge of pollutants.
- Prevent recurrence of reportable quantity releases of hazardous material or oil.

8.0 TERMINATION CHECKLIST:

The following items shall be complete before submitting the NOT:

- All soil disturbing activities are complete.
- Temporary erosion and sediment control measures have been removed or will be removed at an appropriate time.
- All areas of the construction site not otherwise covered by permanent pavement or structure have been stabilized with uniform perennial vegetative cover with a density of 70% or equivalent measures have been employed.

RBA
REBOL-BATTLE & ASSOCIATES
Civil Engineers and Surveyors
2301 N. Ninth Avenue, Suite 300
Tallahassee, Florida 32304
Telephone: 850.438.1400 Fax: 850.438.0448
EE: 00009657 LE7916

NPDES - STORMWATER
POLLUTION PREVENTION
PLAN

GULF BEACH
SELF STORAGE
8939 GULF BEACH HIGHWAY
ESCAMBIA COUNTY, FLORIDA

REVISION	DATE	DESCRIPTION

PAUL A. LICHT
PROFESSIONAL ENGINEER
No. 83126
STATE OF FLORIDA
PAUL A. BATTLE, P.E.
No. 53126
PAUL A. KAH
No. 11448
Job No.: 2017.285
Date: 06/15/2021

DRAWING No.
C1.2

This drawing is the property of Rebol-Battle & Associates, and may not be reproduced without written permission.

NO.	DATE	REVISION

SEAL
 No. 342 FOR CONSTRUCTION
 STATE OF FLORIDA
 PROFESSIONAL ENGINEER
 KAH
 PAB
 Job No.: 2017.285
 Date: 06/15/2021
 DRAWING No.
C2.0

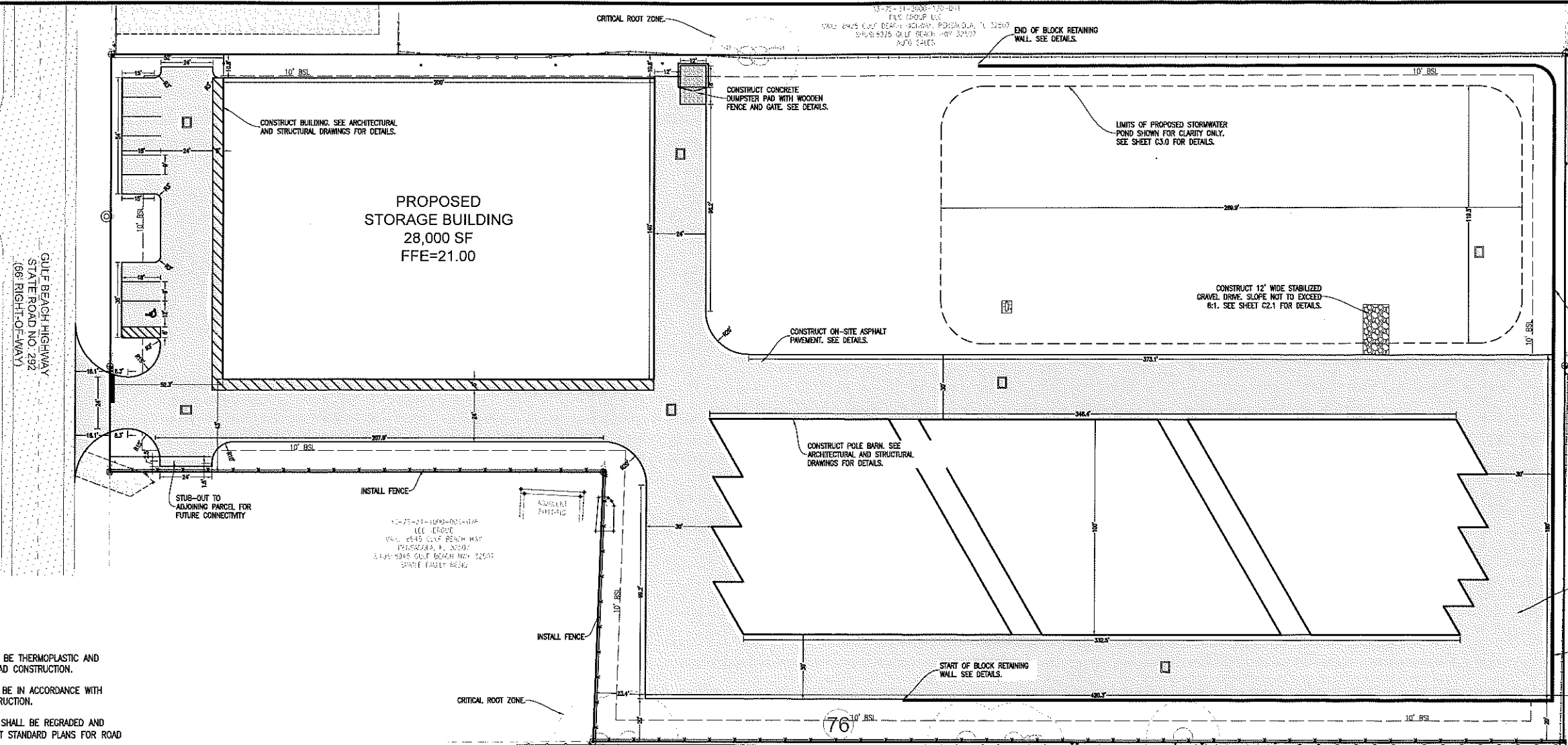

- GENERAL NOTES:**
- ALL PAVEMENT MARKINGS AND STRIPING SHALL BE THERMOPLASTIC AND INSTALLED PER LATEST STANDARD PLANS FOR ROAD CONSTRUCTION.
 - ALL CONSTRUCTION IN RIGHTS-OF-WAY SHALL BE IN ACCORDANCE WITH LATEST FDOT STANDARD PLANS FOR ROAD CONSTRUCTION.
 - ALL DISTURBED AREAS IN THE RIGHT-OF-WAY SHALL BE REGRADED AND SODDED AND/OR SEED AND MULCHED PER LATEST STANDARD PLANS FOR ROAD CONSTRUCTION.
 - ALL NEEDED STRIPING DESTROYED DURING CONSTRUCTION SHALL BE RE-STRIPED ACCORDING TO LATEST STANDARD PLANS FOR ROAD CONSTRUCTION.
 - ALL LANES MUST BE OPEN FOR TRAFFIC DURING AN EVACUATION NOTICE OF A HURRICANE OR OTHER CATASTROPHIC EVENT AND SHALL REMAIN OPEN FOR THE DURATION OF THE EVACUATION OR EVENT AS DIRECTED BY THE LOCAL MAINTENANCE ENGINEER OR HIS DESIGNEE.
 - ALL SIGNS SHALL BE INSTALLED PER LATEST STANDARD PLANS FOR ROAD CONSTRUCTION, WIND ZONE No.1.
 - THE DEPARTMENT WILL REVIEW ALL LANE, DETOUR AND LAND SHIFT REQUESTS SEPARATELY FROM THE PERMIT PROCESS. FDOT APPROVAL IS REQUIRED BEFORE COMMENCEMENT OF WORK INVOLVING THE CLOSURE, DETOUR, OR LANE SHIFT FOR WORK ALONG THE STATE HIGHWAY SYSTEM. IF A LANE CLOSURE IS NEEDED, SUBMIT A WRITTEN REQUEST WITH PROPOSED DATES/TIMES/MOT PLAN. ALLOW AT LEAST 2 WEEKS IN YOUR SCHEDULING FOR THIS SPECIAL REVIEW.
 - THE PROJECT ENGINEER (ENGINEER OF RECORD) SHALL PROVIDE TO ESCAMBA COUNTY "AS-BUILT" RECORD DRAWINGS FOR VERIFICATION AND APPROVAL BY ESCAMBA COUNTY ONE WEEK PRIOR TO REQUESTING A FINAL INSPECTION AND CERTIFICATE OF OCCUPANCY, OR PROVIDE "AS-BUILT" CERTIFICATION THAT THE PROJECT CONSTRUCTION ADHERES TO THE PERMITTED PLANS AND SPECIFICATIONS. THE "AS-BUILT" CERTIFICATION OR THE "AS-BUILT" RECORD DRAWINGS MUST BE SIGNED, SEALED, AND DATED BY A REGISTERED FLORIDA PROFESSIONAL ENGINEER.
 - THE OWNER OR HIS AGENT SHALL ARRANGE/SCHEDULE WITH THE COUNTY A FINAL INSPECTION OF THE DEVELOPMENT UPON COMPLETION AND ANY INTERMEDIATE INSPECTIONS AT (850)595-3472. AS-BUILT CERTIFICATION IS REQUIRED PRIOR TO REQUEST FOR FINAL INSPECTION/APPROVAL.
 - THE CONTRACTOR SHALL NOTIFY FDOT 48 HOURS IN ADVANCE PRIOR TO INITIATING ANY WORK IN THE STATE RIGHTS-OF-WAY.

PROJECT NOTE:
 TRASH PICK-UP WILL BE PROVIDED BY SCREENED ON-SITE DUMPSTER

AREA CALCULATIONS:
EXISTING CONDITIONS:
 TOTAL EXISTING IMPERVIOUS AREA = 0 SF (0%)
 TOTAL EXISTING PERVIOUS AREA = 187,203 SF (100%)
 TOTAL SITE AREA = 187,203 SF

PROPOSED CONDITIONS:
 TOTAL PROPOSED BUILDING AREAS (FOOT PRINTS)= 62,415 SF
 TOTAL PROPOSED IMPERVIOUS AREA = 111,868 SF (60%)
 TOTAL PROPOSED PERVIOUS AREA = 75,335 SF (40%)
 TOTAL SITE AREA = 187,203 SF

PARKING CALCULATIONS:
 ESCAMBA COUNTY LDC SECTION: 3-1.2(d); OTHER USES & RETAIL SERVICES
 TOTAL REQUIRED PARKING SPACES
 OTHER USES: SELF-STORAGE (1.5 SPACES / 100 STORAGE UNITS +2)
 (164/100*1.5)+2 = 4.5 = 5 SPACES
 RETAIL SERVICES: PROFESSIONAL SERVICE OFFICE (3.5 SPACES / 1,000 SF)
 400*3.5/1,000 = 1.4 = 2 SPACES

TOTAL PARKING SPACES REQUIRED = 7
 TOTAL PARKING SPACES PROVIDED = 9
 STANDARD PARKING SPACES = 8
 H.C. PARKING SPACES = 1 H.C.

SIGNAGE NOTE:
 FREESTANDING SIGNAGE: ESCAMBA COUNTY LDC: SEC. 5-8.8(d)(2)(c)
 ONE (1) FREESTANDING SIGN STRUCTURE ALLOWED PER PARCEL STREET FRONTAGE AND ONE ADDITIONAL STRUCTURE FOR EACH FULL ACRE IN DEVELOPMENT PARCEL SIZE ABOVE TWO ACRES, BUT A MAXIMUM FOUR SIGN STRUCTURES ARE ALLOWED REGARDLESS OF FRONTAGE OR ACREAGE. THE STRUCTURES SHALL BE PLACED NO LESS THAN 200 FEET FROM ANY OTHER NON-EXEMPT SIGN STRUCTURES ON THE SAME DEVELOPMENT PARCEL, EXCLUDING BILLBOARDS.

WALL SIGNAGE: ESCAMBA COUNTY LDC: SEC. 5-8.8(d)(2)(b)
 A MAXIMUM 2.25 SQUARE FEET OF WALL SIGN AREA IS ALLOWED PER LINEAL FOOT OF BUILDING FRONTAGE AT GRADE. THE MAXIMUM WALL SIGN AREA IS INCREASED TO 2.50 SQUARE FEET PER LINEAL FOOT FOR ANY BUILDING FRONTAGE FACING AN ARTERIAL OR FOUR-LANE STREET, AND IS INCREASED TO 2.75 SQUARE FEET PER LINEAL FOOT FOR ANY BUILDING FRONTAGE MORE THAN 200 FEET FROM THE PUBLIC STREET RIGHT-OF-WAY. A MINIMUM 20 SQUARE FEET IS ALLOWED FOR ANY INDIVIDUAL TENANT FRONTAGE OF A MULTI-TENANT BUILDING

FREESTANDING SIGNAGE SHALL BE LIMITED TO ONE SIGN A MAXIMUM OF 150 SF IN AREA AND A MAXIMUM OF 25 LF IN HEIGHT (LIMITED BY STREET CLASSIFICATION)

WALL SIGNAGE SHALL BE LIMITED TO A TOTAL SF OF 2.25 x 140 = 315 SF

A VALID ESCAMBA COUNTY SIGN PERMIT MUST BE OBTAINED PRIOR TO CONSTRUCTION OF SIGN.

LEGEND

	EXISTING ASPHALT
	EXISTING CONCRETE
	EXISTING GRAVEL
	EXISTING DIRT
	PROPOSED ASPHALT
	PROPOSED CONCRETE
	RIPRAP

LAND DISTURBING NOTE:
 ALL TREES ARE TO REMAIN ON-SITE AND ALL LAND DISTURBING ACTIVITIES, INCLUDING THE PLACEMENT OF FILL/FILL MATERIALS, GRADING, EXCAVATING, ETC. SHALL NOT OCCUR UNTIL SUCH TIME AS APPROPRIATE PERMIT(S) ARE ISSUED FOR THE PROPOSED WORK.

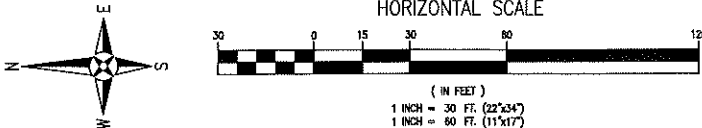

DRAWING NO. C2.0 DATE: 06/15/2021

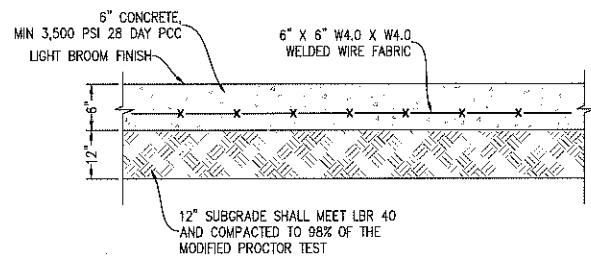

CONCRETE PAVING DETAIL
N.T.S.

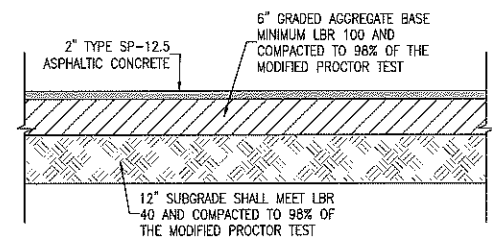

ON-SITE ASPHALT PAVEMENT DETAIL
N.T.S.

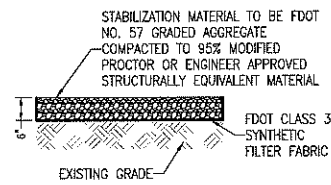

STABILIZED GRAVEL DRIVE SECTION
N.T.S.

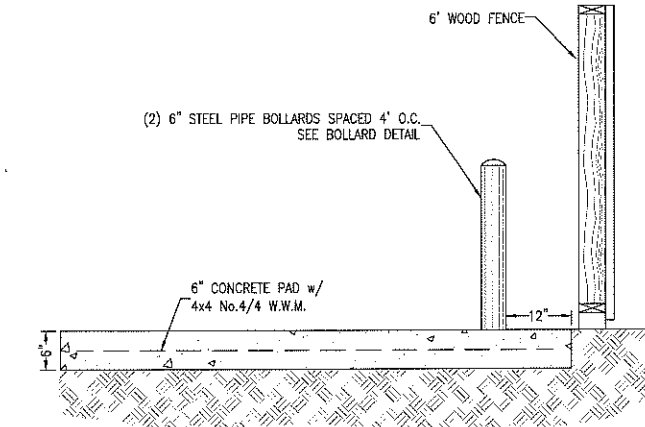

DUMPSTER PAD SECTION

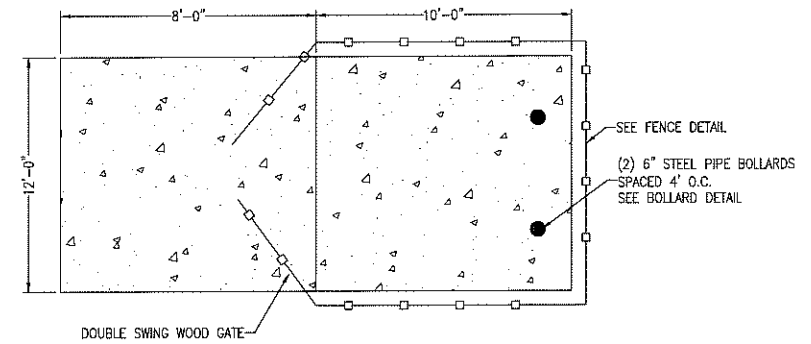

DUMPSTER PAD PLAN VIEW

DUMPSTER PAD DETAIL
N.T.S.

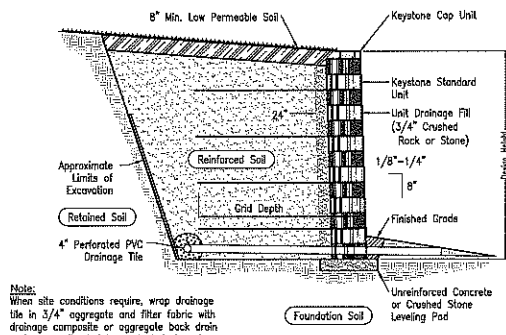

Typical Reinforced Wall Section
Standard Unit - Near Vertical Setback

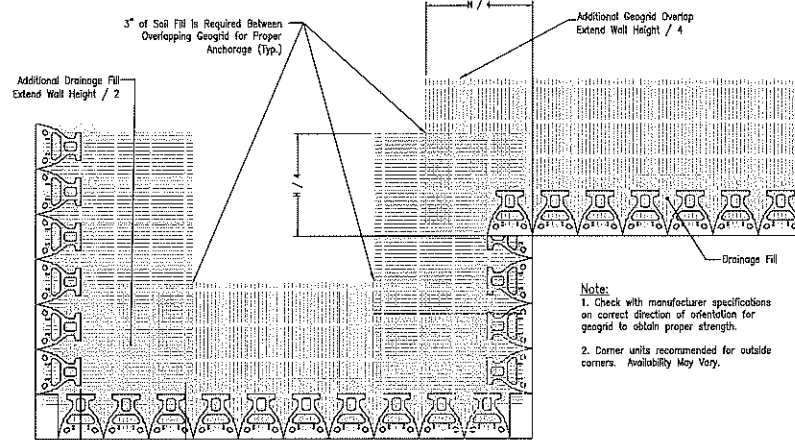

Geogrid Installation at Corners

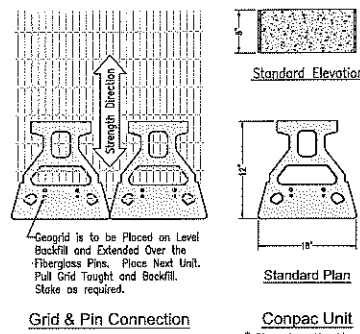

Grid & Pin Connection



Cap Unit Elevation



Cap Unit Plan

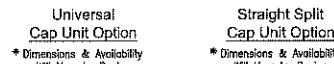

Universal Cap Unit Option

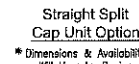

Straight Split Cap Unit Option

Base Leveling Pad Notes:

- The leveling pad is to be constructed of crushed stone or 2,000 psi unreinforced concrete.
- The base foundation is to be approved by the site geotechnical engineer prior to placement of the leveling pad.

	Compac Unit	Cap Unit
Width:	16"	16"
Depth:	12"	10 1/2"
Height:	8"	4"
Weight:	90 lbs	55 lbs

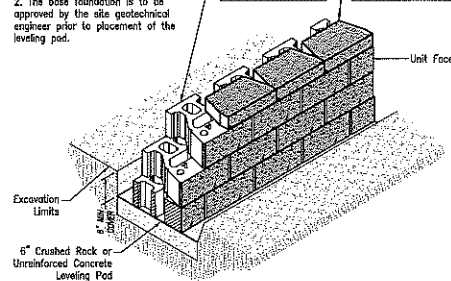

Standard Unit/Base Pad Isometric Section View
*Dimensions & Weight May Vary by Region

RETAINING WALL NOTE:

THE KEYSTONE WALL ILLUSTRATED HAS BEEN PROVIDED AS A REPRESENTATION OF THE TYPE AND QUALITY OF RETAINING WALL TO BE INSTALLED. AN APPROVED EQUIVALENT RETAINING WALL MAY BE INSTALLED IN PLACE OF THE KEYSTONE WALL IF IT WILL BE THE CONTRACTOR'S RESPONSIBILITY TO INSURE THAT THE RETAINING WALL IS INSTALLED PER INDUSTRY AND MANUFACTURERS ACCEPTED STANDARDS.

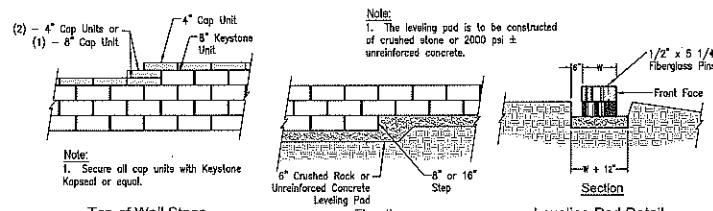

Top of Wall Steps

Leveling Pad Detail

Section

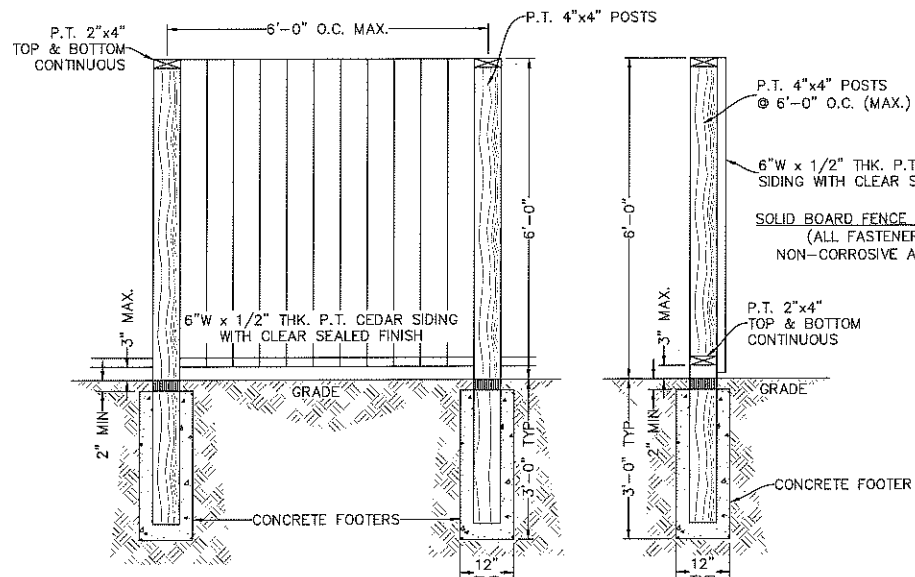

WOOD FENCE DUMPSTER ENCLOSURE DETAIL
N.T.S.

RBA
REBOL-BATTLE & ASSOCIATES
Civil Engineers and Surveyors
2301 N. Ninth Avenue, Suite 300
Tampa, Florida 33606
Telephone: 813.438.1450
Fax: 813.438.1446
E-mail: RBA@REBOL-BATTLE.COM

SITE DETAILS

GULF BEACH SELF STORAGE
8939 GULF BEACH HIGHWAY
ESCAMBIA COUNTY, FLORIDA

NO.	DATE	REVISION

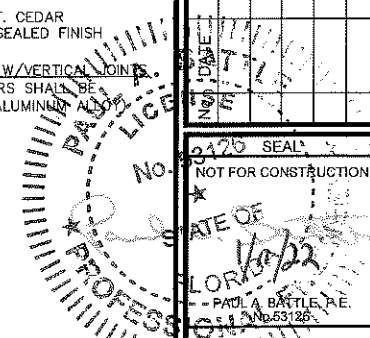

NOT FOR CONSTRUCTION
PAUL A. BATTLE, P.E.
No. 53126
Dr. By: KAH
Ck By: PAB
Job No.: 2017.285
Date: 06/15/2021

DRAWING No.
C2.1

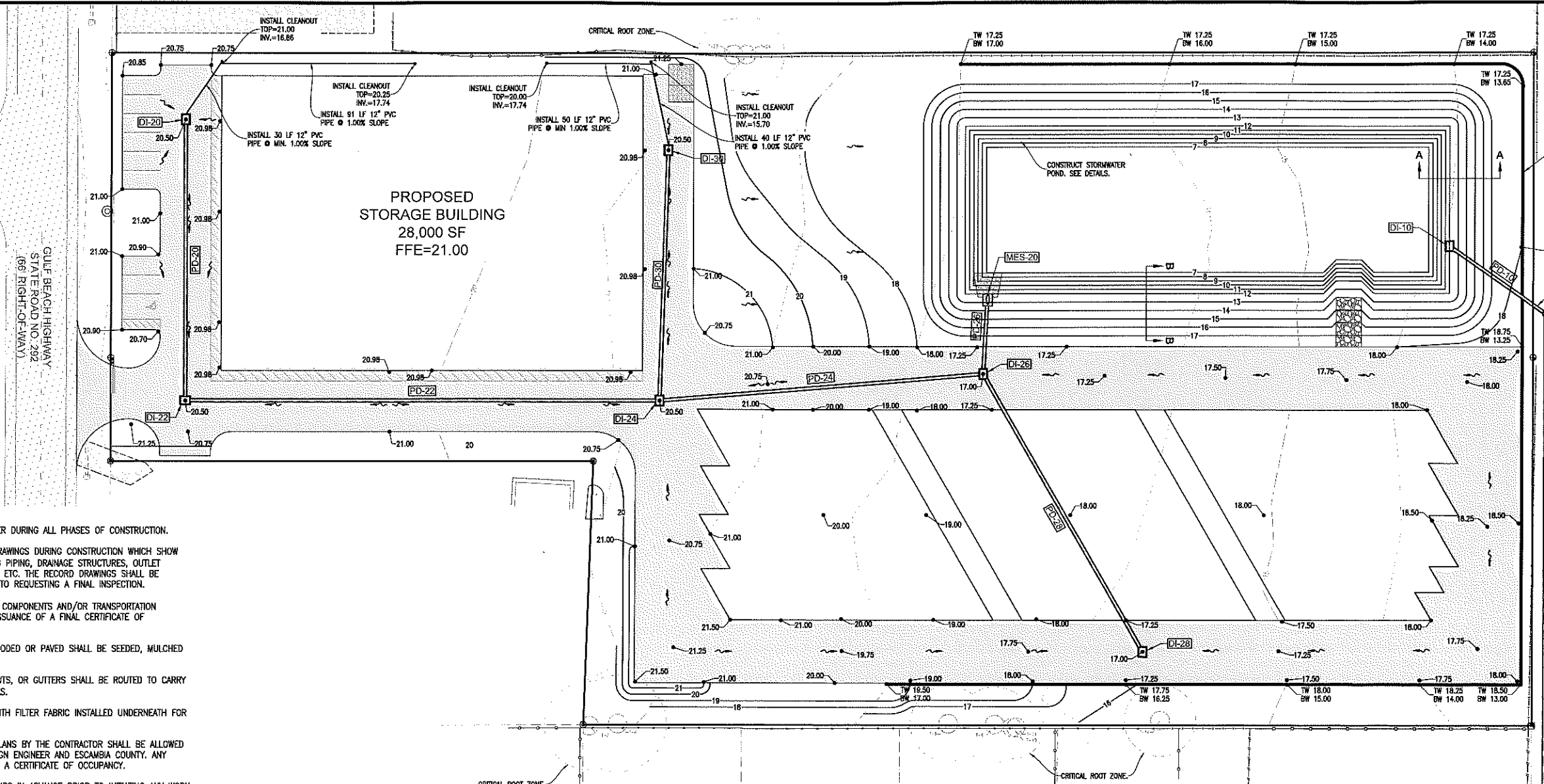

- GENERAL NOTES:**
1. THE CONTRACTOR SHALL CONTROL STORMWATER DURING ALL PHASES OF CONSTRUCTION.
 2. THE CONTRACTOR SHALL MAINTAIN RECORD DRAWINGS DURING CONSTRUCTION WHICH SHOW "AS-BUILT" CONDITIONS OF ALL WORK INCLUDING PIPING, DRAINAGE STRUCTURES, OUTLET STRUCTURES, DIMENSIONS, ELEVATIONS, GRADING, ETC. THE RECORD DRAWINGS SHALL BE PROVIDED TO THE ENGINEER OF RECORD PRIOR TO REQUESTING A FINAL INSPECTION.
 3. ALL ASPECTS OF THE STORMWATER/DRAINAGE COMPONENTS AND/OR TRANSPORTATION COMPONENTS SHALL BE COMPLETED PRIOR TO ISSUANCE OF A FINAL CERTIFICATE OF OCCUPANCY.
 4. ALL DISTURBED AREAS NOT SHOWN TO BE SODDED OR PAVED SHALL BE SEEDED, MULCHED AND FERTILIZED.
 5. ALL NEW BUILDING ROOF DRAINS, DOWN SPOUTS, OR GUTTERS SHALL BE ROUTED TO CARRY ALL STORMWATER TO RETENTION/DETENTION AREAS.
 6. ALL RIP-RAP FLUMES SHALL BE INSTALLED WITH FILTER FABRIC INSTALLED UNDERNEATH FOR THE ENTIRE AREA OF THE RIP-RAP.
 7. NO DEVIATIONS OR REVISIONS FROM THESE PLANS BY THE CONTRACTOR SHALL BE ALLOWED WITHOUT PRIOR APPROVAL FROM BOTH THE DESIGN ENGINEER AND ESCAMBIA COUNTY. ANY DEVIATIONS MAY RESULT IN DELAYS IN OBTAINING A CERTIFICATE OF OCCUPANCY.
 8. THE CONTRACTOR SHALL NOTIFY FDOT 48 HOURS IN ADVANCE PRIOR TO INITIATING ANY WORK IN THE STATE RIGHT-OF-WAY.
 9. THE CONTRACTOR SHALL INSTALL, PRIOR TO THE START OF CONSTRUCTION AND MAINTAIN DURING CONSTRUCTION, ALL SEDIMENT CONTROL MEASURES AS REQUIRED TO RETAIN ALL SEDIMENTS ON THE SITE. IMPROPER SEDIMENT MEASURES MAY RESULT IN CODE ENFORCEMENT VIOLATION(S).
 10. ALL RETENTION/DETENTION AREAS SHALL BE SUBSTANTIALLY COMPLETE PRIOR TO ANY CONSTRUCTION ACTIVITIES THAT MAY INCREASE STORMWATER RUNOFF RATES. THE CONTRACTOR SHALL CONTROL STORMWATER DURING ALL PHASES OF CONSTRUCTION AND TAKE ADEQUATE MEASURES TO PREVENT THE EXCAVATED POND FROM BLINDING DUE TO SEDIMENTS.
 11. NOTIFY SUNSHINE UTILITIES 48 HOURS IN ADVANCE PRIOR TO DIGGING WITHIN RIGHT-OF-WAY. (1-800-432-4770)
 12. THE OPERATION AND MAINTENANCE OF THE FACILITY WILL BE THE RESPONSIBILITY OF THE OWNER, AS IN ACCORDANCE WITH THE APPROVED PERMIT.
 13. DEVELOPER/CONTRACTOR SHALL RESHAPE PER PLAN SPECIFICATIONS, CLEAN OUT ACCUMULATED SILT, AND STABILIZE RETENTION/DETENTION POND AT THE END OF CONSTRUCTION WHEN ALL DISTURBED AREAS HAVE BEEN STABILIZED AND PRIOR TO REQUEST FOR INSPECTION.

DROP INLETS		
NAME	TOP ELEVATION	INVERTS
DI-10 TYPE 'D' POND OUTFALL	16.55	INV=12.00 (PD-10)
DI-20 TYPE 'D' INLET	20.50	INV=16.50 (PD-20)
DI-22 TYPE 'D' INLET	20.50	INV=15.83 (PD-22) INV=15.83 (PD-20)
DI-24 TYPE 'D' INLET	20.50	INV=14.70 (PD-24) INV=14.70 (PD-22) INV=14.70 (PD-30)
DI-26 TYPE 'D' INLET	17.00	INV=13.76 (PD-24) INV=13.74 (PD-26) INV=13.74 (PD-28)
DI-28 TYPE 'D' INLET	17.00	INV=14.50 (PD-28)
DI-30 TYPE 'D' INLET	20.50	INV=15.30 (PD-30)

STORMWATER JUNCTION BOX		
NAME	TOP ELEVATION	INVERTS
JB-10 JUNCTION BOX	14.22	INV=11.72 (PD-10) INV=11.72 (PD-12)
JB-20 JUNCTION BOX	12.47	INV=9.97 (PD-12) INV=9.97 (PD-14)

MITERED END SECTIONS	
NAME	INVERT
MES-10	INV=9.68' (PD-14)
MES-20	INV=12.00' (PD-26)

PIPE TABLE			
Pipe Name	Length	Size	Slope
PD-10	56'	18" HDPE	0.50%
PD-12	350'	18" HDPE	0.50%
PD-14	55'	18" RCP	0.52%
PD-20	133'	18" HDPE	0.50%
PD-22	225'	18" HDPE	0.50%
PD-24	154'	18" HDPE	0.61%
PD-26	38'	18" HDPE	4.57%
PD-28	152'	18" HDPE	0.50%
PD-30	119'	18" HDPE	0.50%

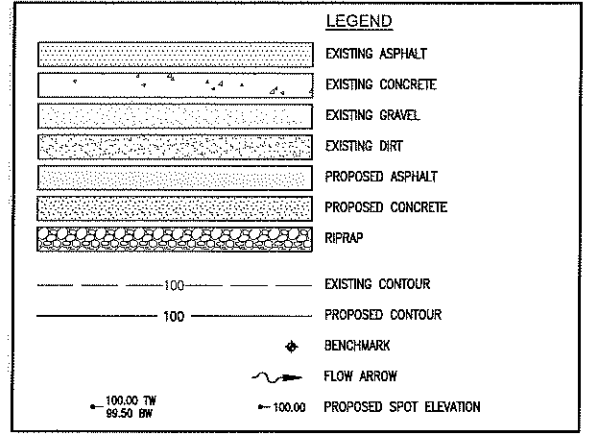

- TREE PROTECTION NOTES:**
1. NO UN-PERMITTED GRADING OR CLEARING BY HEAVY EQUIPMENT SHOULD HAPPEN UNDER THE DRIPLINE OF PROTECTED TREES ON SITE.
 2. STORAGE OF HEAVY EQUIPMENT SHALL NOT OCCUR UNDER THE DRIPLINE OF PROTECTED TREES ON SITE.
 3. NO PROTECTED TREES INDICATED FOR PRESERVATION SHALL BE REMOVED, DESTRUCTIVELY DAMAGED, MUTILATED, RELOCATED, DISFIGURED, DESTROYED, CUT DOWN OR EXCESSIVELY PRUNED.
 4. FOR VIABILITY OF PROTECTED TREES REMAINING ON SITE, THE ROOTS OF 1" DIAMETER OR GREATER SHALL BE CUT CLEANLY WITH APPROPRIATE EQUIPMENT. DO NOT USE EQUIPMENT THAT PULLS AND SHATTERS ROOTS (E.G. BACKHOE). ROOTS SHALL BE PRUNED TO A DEPTH OF 18" BELOW THE EXISTING GRADE OR TO A DEPTH OF DISTURBANCE IF LESS THAN 18" FROM EXISTING GRADE.
 5. ALL ADEQUATE TREE PROTECTION MEASURES AND BARRICADES SHALL BE INSTALLED PRIOR TO SITE DISTURBANCE AND MAINTAINED IN GOOD WORKING ORDER UNTIL PROJECT IS COMPLETE AND SITE BECOMES STABILIZED.

OFF-SITE PIPE NOTE:
 PROPOSED 18" OVERFLOW DISCHARGE PIPE SHALL BE DEVELOPER'S RESPONSIBILITY FOR MAINTENANCE.

LAND DISTURBING NOTE:
 ALL TREES ARE TO REMAIN ON SITE AND ALL LAND DISTURBING ACTIVITIES, INCLUDING THE PLACEMENT OF FILL/FILL MATERIALS, GRADING, EXCAVATING, ETC. SHALL NOT OCCUR UNTIL SUCH TIME AS APPROPRIATE PERMIT(S) ARE ISSUED FOR THE PROPOSED WORK.

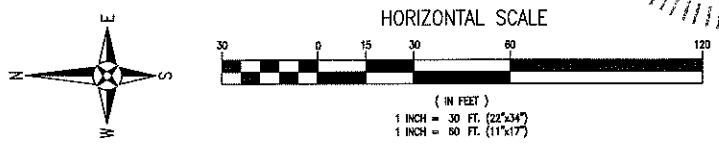

WADE AVENUE (50' RIGHT-OF-WAY)

SEE OFF-SITE PIPE NOTE.

PROFESSIONAL SEAL
 PAUL A. BATTLE, P.E.
 No. 63126
 State of Florida
 Date: 06/15/2021

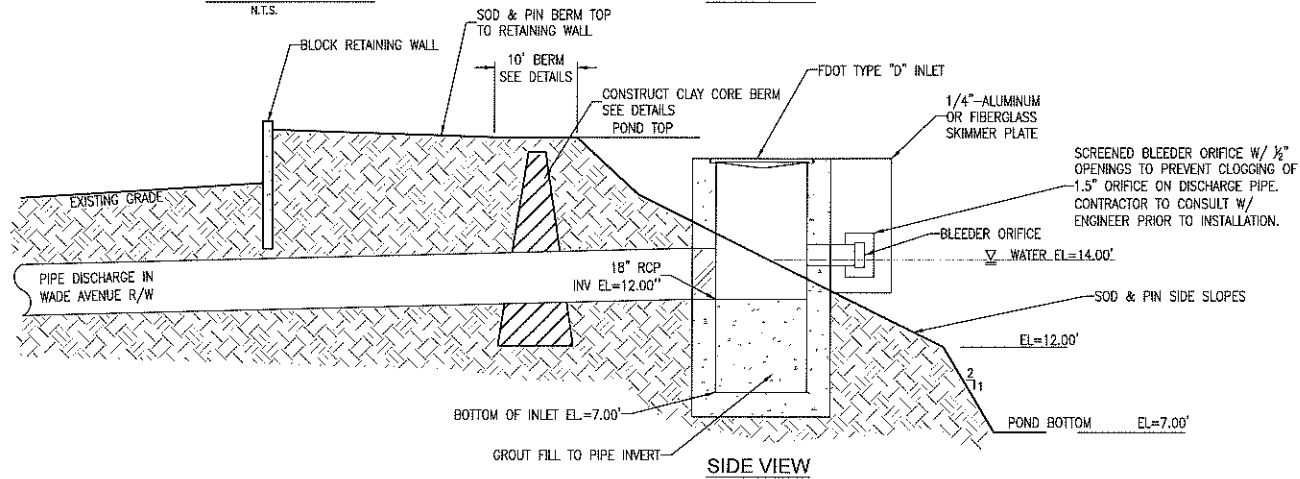
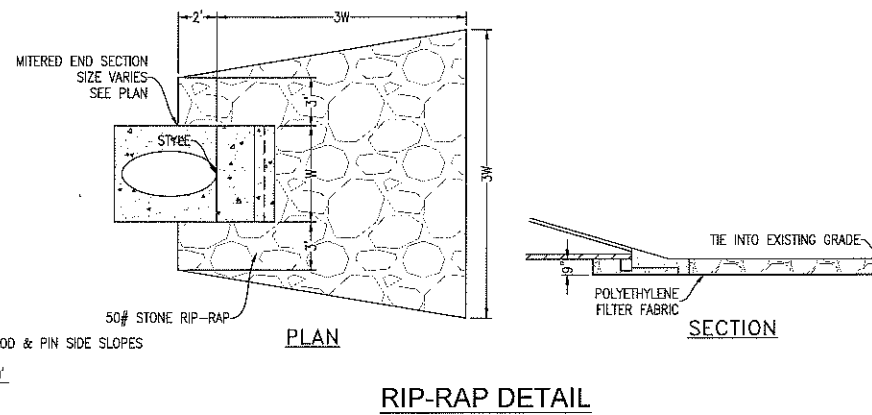
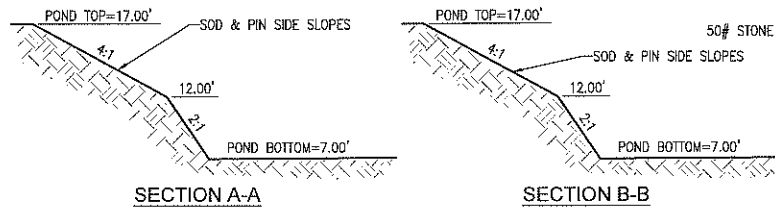
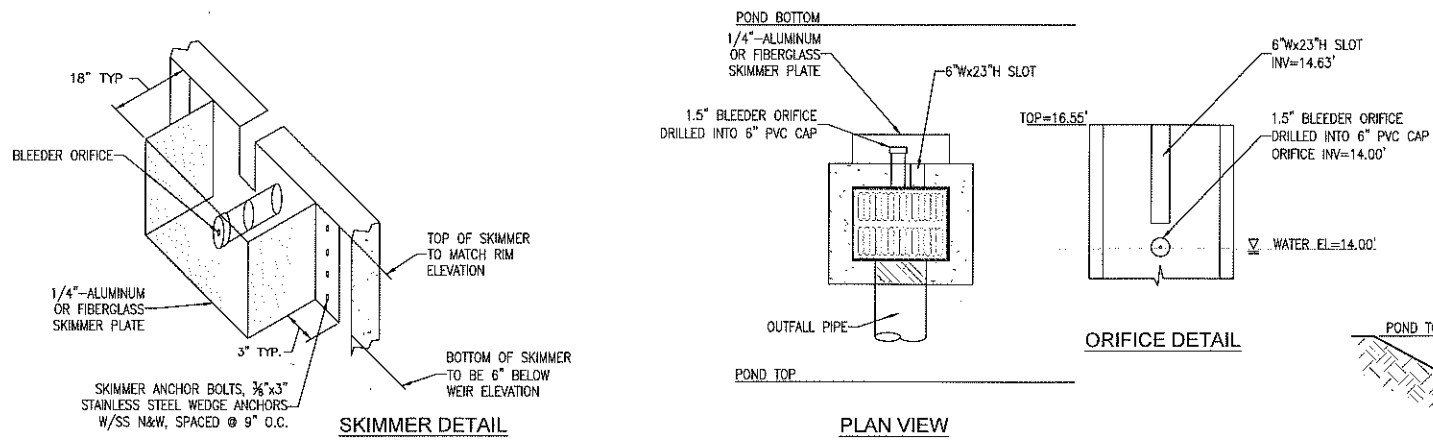

OUTFALL/LEVEL CONTROL STRUCTURE DETAIL
N.T.S.

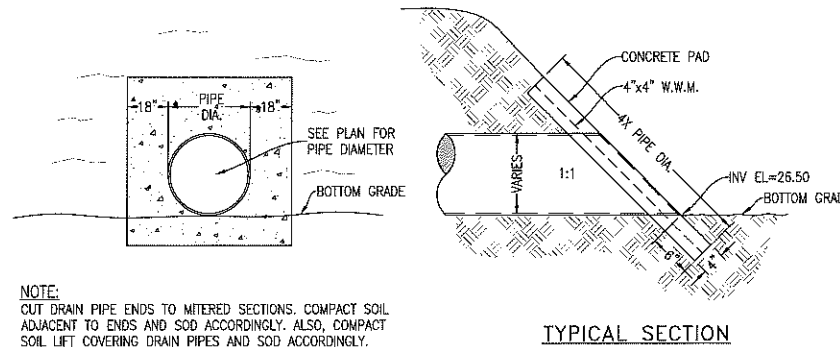

MITERED END SECTION
N.T.S.

- NOTES:
1. MANHOLE SHALL CONFORM TO A.S.T.M. C 478 SPECIFICATIONS WITH 4000 PSI CONCRETE.
 2. DIAMETER OF OPENING FOR PIPE SHALL BE 1\"/>

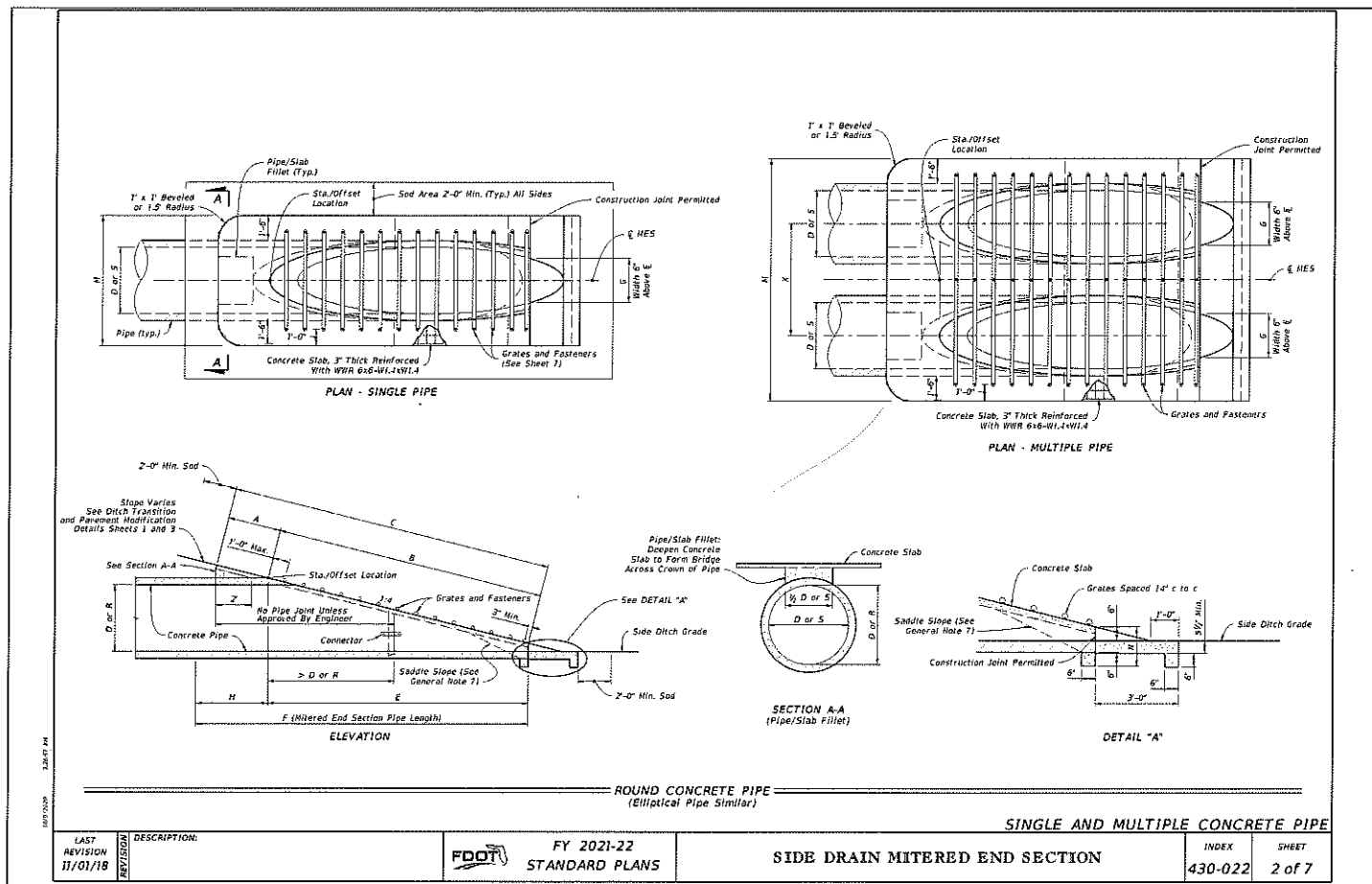

SINGLE AND MULTIPLE CONCRETE PIPE

LAST REVISION	DESCRIPTION
11/01/18	

FDOT FY 2021-22 STANDARD PLANS

SIDE DRAIN MITERED END SECTION

INDEX SHEET 430-022 2 of 7

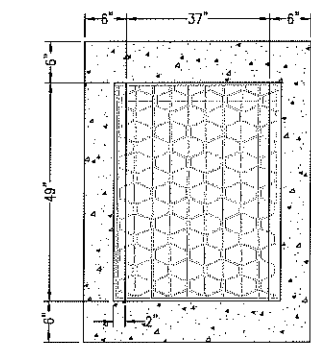

FDOT TYPE 'D' INLET
N.T.S.

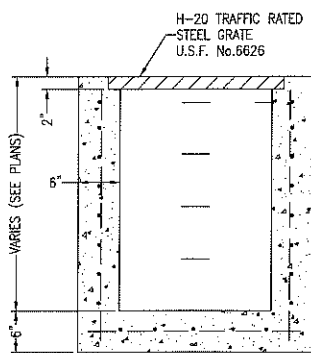

STORMWATER MANHOLE DETAIL
N.T.S.

RBA
REBOL-BATTLE & ASSOCIATES
Civil Engineers and Surveyors
2501 N. Ninth Avenue, Suite 300
Tallahassee, Florida 32310
Telephone 850.438.0400 Fax 850.438.0448
E-mail: info@rba.com

GRADING & DRAINAGE
DETAILS

GULF BEACH
SELF STORAGE
8939 GULF BEACH HIGHWAY
ESCAMBIA COUNTY, FLORIDA

REVISION	DATE	BY	DESCRIPTION

NOT FOR CONSTRUCTION

126

PAUL A. REBOL

PROFESSIONAL ENGINEER

STATE OF FLORIDA

NO. 51226

PAUL A. REBOL, P.E.
No. 51226

DATE: 06/15/2021

Job No.: 2017.285

DRAWING No. C3.1

This drawing is the property of Rebol-Battle & Associates, and may not be reproduced without written permission.

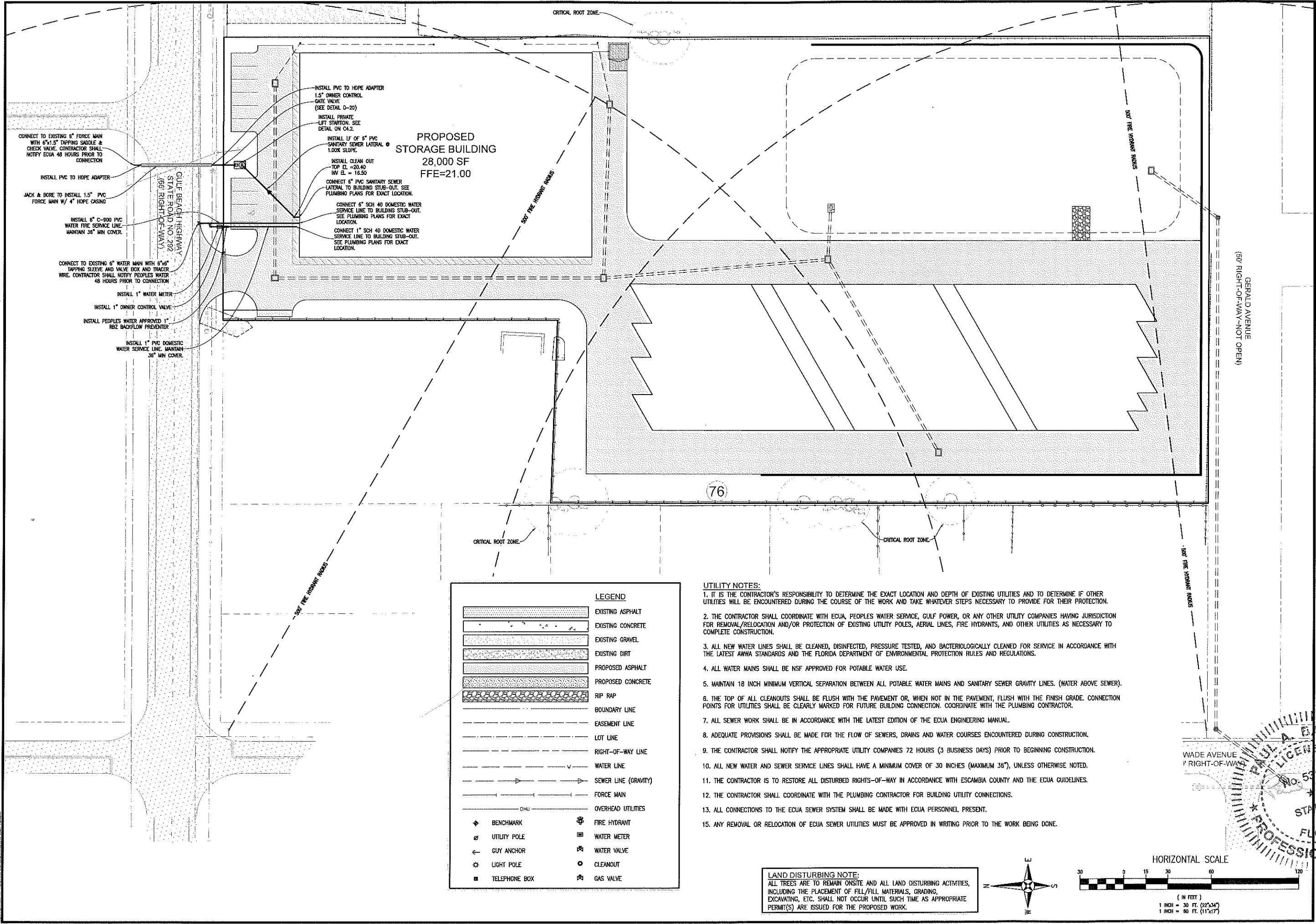

INSTALL PVC TO HOPE ADAPTER
 1.5" OWNER CONTROL
 GATE VALVE
 (SEE DETAIL 0-20)
 INSTALL PRIVATE
 LIFT STATION. SEE
 DETAIL ON C4.2.
 INSTALL LF OF 6" PVC
 SANITARY SEWER LATERAL @
 1.00% SLOPE.
 INSTALL CLEAN OUT
 TOP EL. = 20.40
 INV. EL. = 16.50
 CONNECT 6" PVC SANITARY SEWER
 LATERAL TO BUILDING STUB-OUT. SEE
 PLUMBING PLANS FOR EXACT LOCATION.
 CONNECT 6" SCH 40 DOMESTIC WATER
 SERVICE LINE TO BUILDING STUB-OUT.
 SEE PLUMBING PLANS FOR EXACT
 LOCATION.
 CONNECT 1" SCH 40 DOMESTIC WATER
 SERVICE LINE TO BUILDING STUB-OUT.
 SEE PLUMBING PLANS FOR EXACT
 LOCATION.

**PROPOSED
 STORAGE BUILDING**
 28,000 SF
 FFE=21.00

CONNECT TO EXISTING 6" FORCE MAIN
 WITH 6"x1.5" TAPPING SADDLE &
 CHECK VALVE. CONTRACTOR SHALL
 NOTIFY ECUA 48 HOURS PRIOR TO
 CONNECTION
 INSTALL PVC TO HOPE ADAPTER
 JACK & BORE TO INSTALL 1.5" PVC
 FORCE MAIN W/ 4" HOPE CASING
 INSTALL 6" C-900 PVC
 WATER FIRE SERVICE LINE.
 MAINTAIN 36" MIN COVER.
 GULF BEACH HIGHWAY
 STATE ROAD NO. 292
 (50' RIGHT-OF-WAY)
 CONNECT TO EXISTING 6" WATER MAIN WITH 6"x6"
 TAPPING SLEEVE AND VALVE BOX AND TRACER
 WIRE. CONTRACTOR SHALL NOTIFY PEOPLES WATER
 48 HOURS PRIOR TO CONNECTION
 INSTALL 1" WATER METER
 INSTALL 1" OWNER CONTROL VALVE
 INSTALL PEOPLES WATER APPROVED 1"
 RBZ BACKFLOW PREVENTER
 INSTALL 1" PVC DOMESTIC
 WATER SERVICE LINE. MAINTAIN
 36" MIN COVER.

LEGEND

[Pattern]	EXISTING ASPHALT	[Symbol]	FIRE HYDRANT
[Pattern]	EXISTING CONCRETE	[Symbol]	WATER METER
[Pattern]	EXISTING GRAVEL	[Symbol]	WATER VALVE
[Pattern]	EXISTING DIRT	[Symbol]	CLEANOUT
[Pattern]	PROPOSED ASPHALT	[Symbol]	GAS VALVE
[Pattern]	PROPOSED CONCRETE	[Symbol]	
[Pattern]	RIP RAP	[Symbol]	
[Line]	BOUNDARY LINE	[Symbol]	
[Line]	EASEMENT LINE	[Symbol]	
[Line]	LOT LINE	[Symbol]	
[Line]	RIGHT-OF-WAY LINE	[Symbol]	
[Line]	WATER LINE	[Symbol]	
[Line]	SEWER LINE (GRAVITY)	[Symbol]	
[Line]	FORCE MAIN	[Symbol]	
[Line]	OVERHEAD UTILITIES	[Symbol]	
[Symbol]	BENCHMARK	[Symbol]	
[Symbol]	UTILITY POLE	[Symbol]	
[Symbol]	GUY ANCHOR	[Symbol]	
[Symbol]	LIGHT POLE	[Symbol]	
[Symbol]	TELEPHONE BOX	[Symbol]	

- UTILITY NOTES:**
- IT IS THE CONTRACTOR'S RESPONSIBILITY TO DETERMINE THE EXACT LOCATION AND DEPTH OF EXISTING UTILITIES AND TO DETERMINE IF OTHER UTILITIES WILL BE ENCOUNTERED DURING THE COURSE OF THE WORK AND TAKE WHATEVER STEPS NECESSARY TO PROVIDE FOR THEIR PROTECTION.
 - THE CONTRACTOR SHALL COORDINATE WITH ECUA, PEOPLES WATER SERVICE, GULF POWER, OR ANY OTHER UTILITY COMPANIES HAVING JURISDICTION FOR REMOVAL/RELOCATION AND/OR PROTECTION OF EXISTING UTILITY POLES, AERIAL LINES, FIRE HYDRANTS, AND OTHER UTILITIES AS NECESSARY TO COMPLETE CONSTRUCTION.
 - ALL NEW WATER LINES SHALL BE CLEANED, DISINFECTED, PRESSURE TESTED, AND BACTERIOLOGICALLY CLEANED FOR SERVICE IN ACCORDANCE WITH THE LATEST AWWA STANDARDS AND THE FLORIDA DEPARTMENT OF ENVIRONMENTAL PROTECTION RULES AND REGULATIONS.
 - ALL WATER MAINS SHALL BE NSF APPROVED FOR POTABLE WATER USE.
 - MAINTAIN 18 INCH MINIMUM VERTICAL SEPARATION BETWEEN ALL POTABLE WATER MAINS AND SANITARY SEWER GRAVITY LINES. (WATER ABOVE SEWER).
 - THE TOP OF ALL CLEANOUTS SHALL BE FLUSH WITH THE PAVEMENT OR, WHEN NOT IN THE PAVEMENT, FLUSH WITH THE FINISH GRADE. CONNECTION POINTS FOR UTILITIES SHALL BE CLEARLY MARKED FOR FUTURE BUILDING CONNECTION. COORDINATE WITH THE PLUMBING CONTRACTOR.
 - ALL SEWER WORK SHALL BE IN ACCORDANCE WITH THE LATEST EDITION OF THE ECUA ENGINEERING MANUAL.
 - ADEQUATE PROVISIONS SHALL BE MADE FOR THE FLOW OF SEWERS, DRAINS AND WATER COURSES ENCOUNTERED DURING CONSTRUCTION.
 - THE CONTRACTOR SHALL NOTIFY THE APPROPRIATE UTILITY COMPANIES 72 HOURS (3 BUSINESS DAYS) PRIOR TO BEGINNING CONSTRUCTION.
 - ALL NEW WATER AND SEWER SERVICE LINES SHALL HAVE A MINIMUM COVER OF 30 INCHES (MAXIMUM 36"), UNLESS OTHERWISE NOTED.
 - THE CONTRACTOR IS TO RESTORE ALL DISTURBED RIGHTS-OF-WAY IN ACCORDANCE WITH ESCAMBIA COUNTY AND THE ECUA GUIDELINES.
 - THE CONTRACTOR SHALL COORDINATE WITH THE PLUMBING CONTRACTOR FOR BUILDING UTILITY CONNECTIONS.
 - ALL CONNECTIONS TO THE ECUA SEWER SYSTEM SHALL BE MADE WITH ECUA PERSONNEL PRESENT.
 - ANY REMOVAL OR RELOCATION OF ECUA SEWER UTILITIES MUST BE APPROVED IN WRITING PRIOR TO THE WORK BEING DONE.

LAND DISTURBING NOTE:
 ALL TREES ARE TO REMAIN ONSITE AND ALL LAND DISTURBING ACTIVITIES, INCLUDING THE PLACEMENT OF FILL/FILL MATERIALS, GRADING, EXCAVATING, ETC. SHALL NOT OCCUR UNTIL SUCH TIME AS APPROPRIATE PERMIT(S) ARE ISSUED FOR THE PROPOSED WORK.

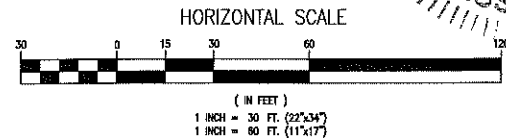
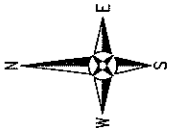

RBA
REBOL-BATTLE & ASSOCIATES
 Civil Engineers and Surveyors
 2301 N. Nair Avenue, Suite 300
 Tallahassee, Florida 32304
 Telephone: 904.438.0400 Fax: 904.438.0448
 EB 00009657 LB7916

UTILITY PLAN

**GULF BEACH
 SELF STORAGE**
 8939 GULF BEACH HIGHWAY
 ESCAMBIA COUNTY, FLORIDA

NO.	DATE	REVISION

WADE AVENUE
 RIGHT-OF-WAY

PROFESSIONAL SEAL
 PAUL A. BATTLE
 LICENSE NO. 53126
 STATE OF FLORIDA
 P.E.
 No. 53126

NOT FOR CONSTRUCTION

DR. BY: KAH
 GKA: RAB
 Job No.: 2017.285
 Date: 08/15/2021

DRAWING No.
C4.0

This drawing is the property of Rebol-Battle & Associates and may not be reproduced without written permission.

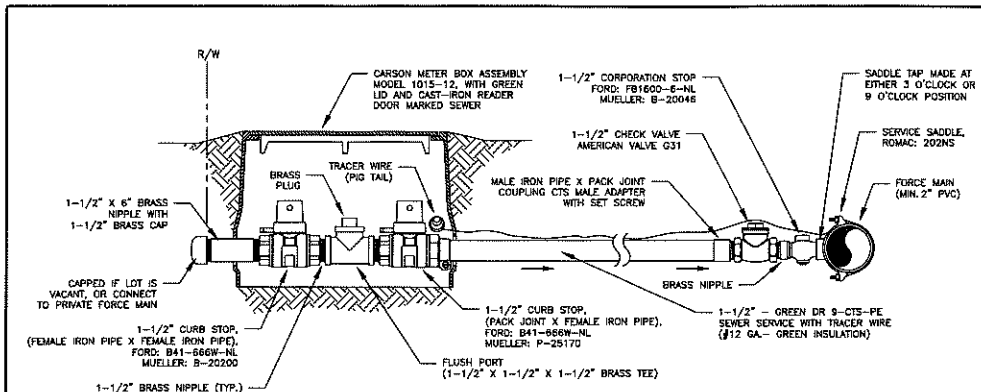

- NOTES:
1. THIS DETAIL APPLIES TO ALL 1-1/2" LOW PRESSURE SEWER SERVICES, RESIDENTIAL AND COMMERCIAL.
 2. EACH CUSTOMER SHALL HAVE A SEPARATE SERVICE. SERVICES SHALL BE LOCATED ON OPPOSITE LOT LINE FROM WATER METERS PER APPROVED PLANS. CONSULT WITH ECUA INSPECTOR IF UNCLEAR.
 3. GRINDER STATION SHALL BE OWNED AND MAINTAINED BY THE PROPERTY OWNER.
 4. EACH GRINDER PUMP SHALL BE CAPABLE OF DELIVERING 12 GPM AT A MINIMUM HEAD CONDITION OF 115' (50 PSI) OR MORE, UNLESS OTHERWISE APPROVED BY ECUA ENGINEERING. PUMP SHALL BE SIZED AND SPECIFIED BY THE ENGINEER OF RECORD WITH SELECTION SHOWN ON ECUA APPROVED PLANS, AND PLUMBERS/SUPPLIERS SHALL SUPPLY PUMP THAT MEETS OR EXCEEDS SAID SELECTION BASED ON SITE CONDITIONS. A CHECK VALVE AND BALL VALVE SHALL BE SUPPLIED AT THE GRINDER STATION.
 5. IF SERVICE IS INSTALLED UNDER ROAD, THEN A 3" HDPE SDR 17 GREEN, OR 3" HDPE SDR 17 GREEN-STRIPED CASING SHALL BE INSTALLED.

1-1/2" LOW PRESSURE SEWER SERVICE

SCALE: N.T.S.
DATE: 8/04/2021

DETAIL: **D-20**

RBA
REBOL-BATTLE & ASSOCIATES
 Civil Engineers and Surveyors
 2301 N. Ninth Avenue, Suite 300
 Telephone: 850.438.0440 Fax: 850.438.0448
 EB: 00009557 LB7916

UTILITY DETAILS

**GULF BEACH
 SELF STORAGE**
 8939 GULF BEACH HIGHWAY
 ESCAMBIA COUNTY, FLORIDA

No.	DATE	REVISION

NOT FOR CONSTRUCTION

58126
 1/11/22
 PAULA BATTLE, P.E.
 STATE OF FLORIDA
 LICENSE NO. 58126

PAUL A. BATTLE
 LICENSE NO. 58126
 PROFESSIONAL ENGINEER

DATE: 06/16/2021
 DRAWING No. **C4.1**

This drawing is the property of Rebol-Battle & Associates, and may not be reproduced without written permission.

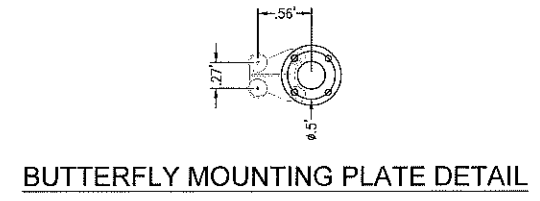
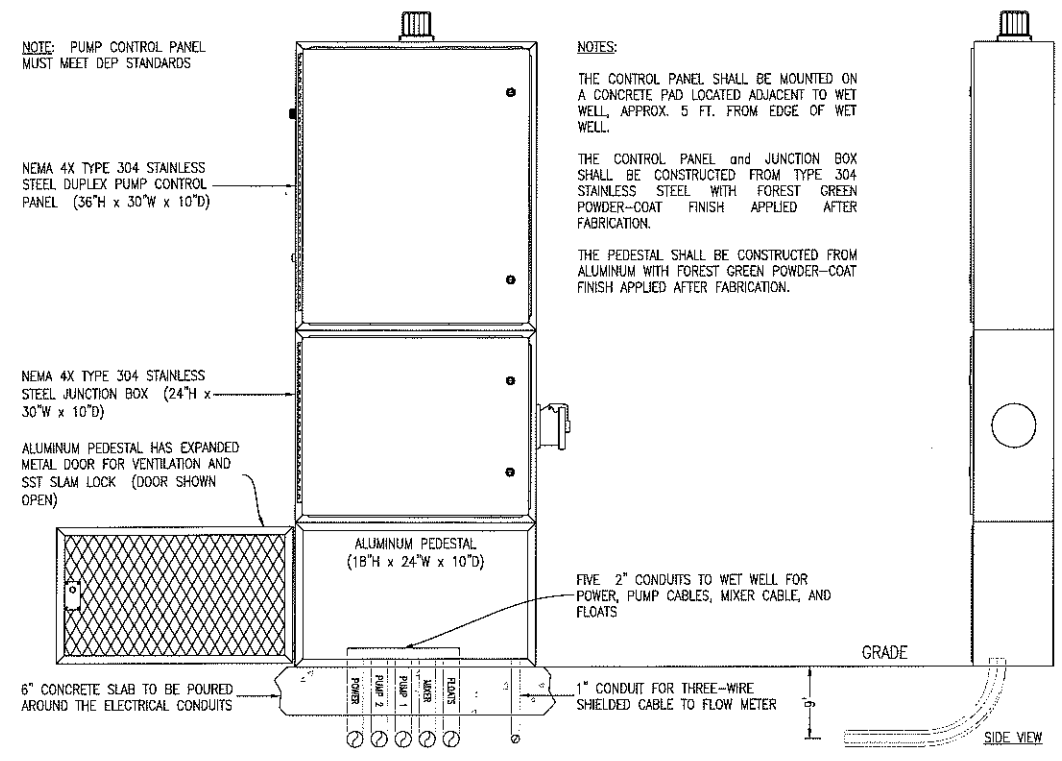
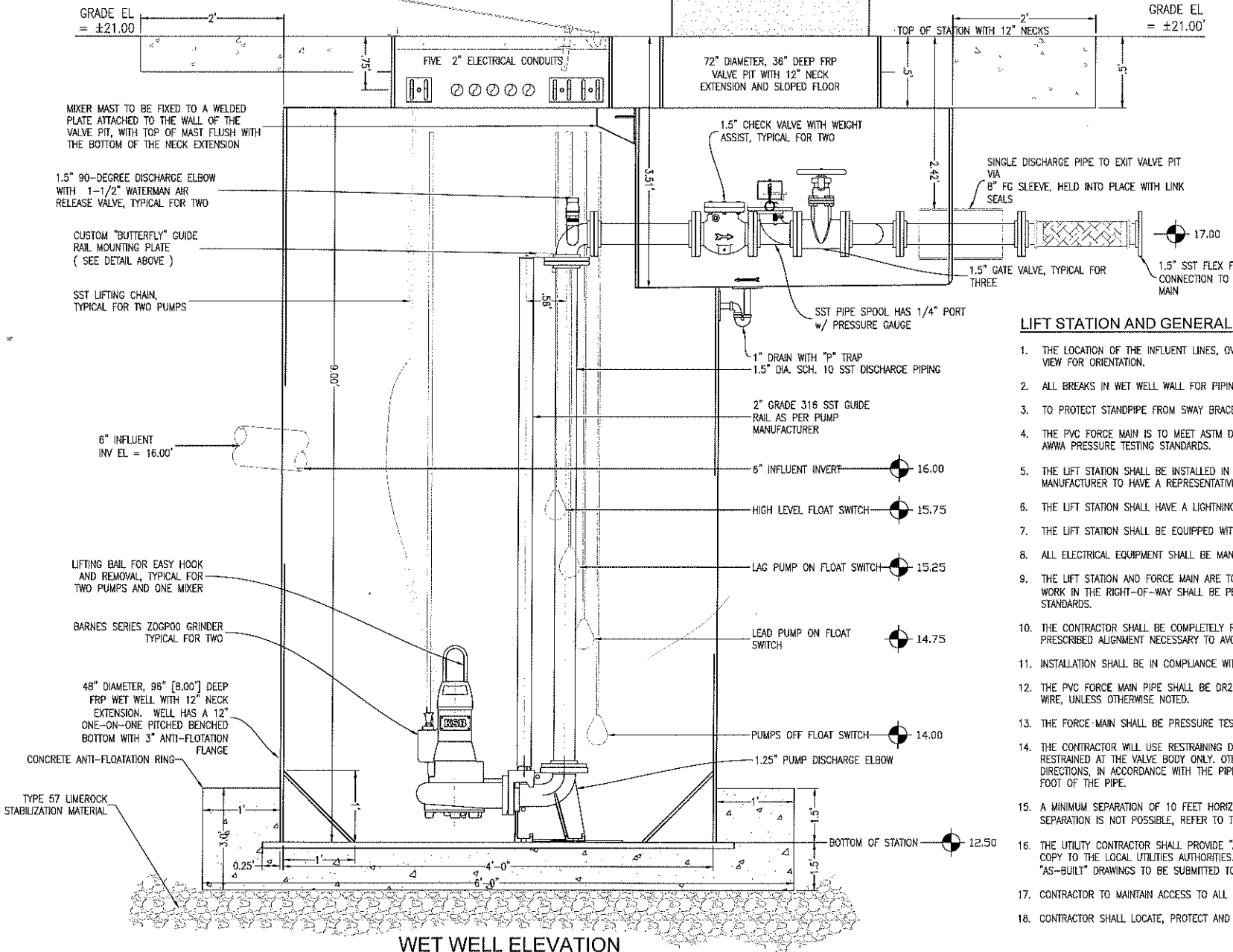
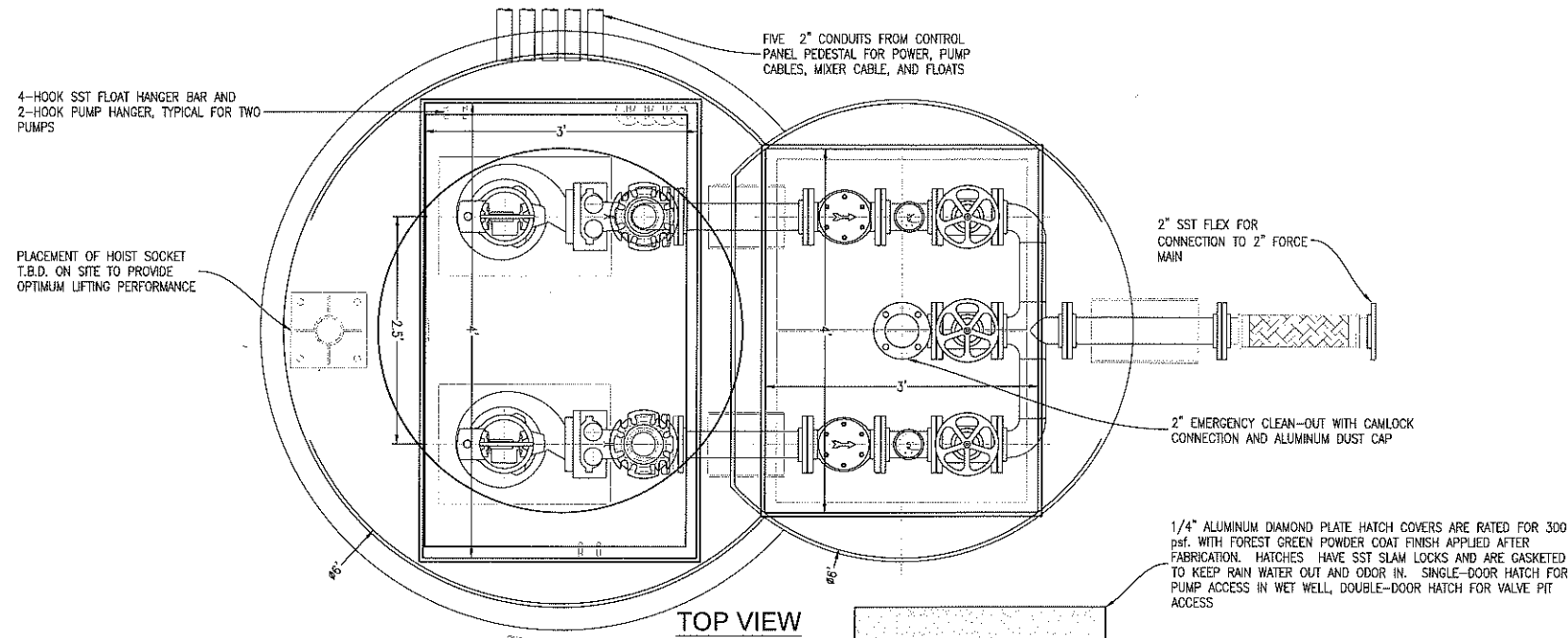

LIFT STATION AND GENERAL UTILITY NOTES:

1. THE LOCATION OF THE INFLUENT LINES, OVERFLOW CONTROL LINES, WATER SUPPLY, ETC. ARE DRAWN OUT OF ORIENTATION ON SECTIONAL VIEW. SEE PLAN VIEW FOR ORIENTATION.
2. ALL BREAKS IN WET WELL WALL FOR PIPING, ELECTRICAL, ETC. SHALL BE SEALED AND SLEEVED AS NOTED.
3. TO PROTECT STANDPIPE FROM SWAY BRACE, EITHER WRAP PIPE WITH RUBBER OR INSERT ALL U-BOLTS THROUGH RUBBER HOSE.
4. THE PVC FORCE MAIN IS TO MEET ASTM D-2241, SDR 26 BELL TYPE JOINTS WITH RING TYPE NEOPRENE GASKETS. THE FORCE MAIN IS TO BE TESTED TO AWWA PRESSURE TESTING STANDARDS.
5. THE LIFT STATION SHALL BE INSTALLED IN ACCORDANCE WITH THE MANUFACTURER'S RECOMMENDATIONS. THE CONTRACTOR SHALL COORDINATE WITH THE MANUFACTURER TO HAVE A REPRESENTATIVE ONSITE DURING INSTALLATION.
6. THE LIFT STATION SHALL HAVE A LIGHTNING ARRESTER INSTALLED BETWEEN EACH INCOMING POWER PHASE AND GROUND.
7. THE LIFT STATION SHALL BE EQUIPPED WITH A RISER, GATE VALVE, QUICK-COUPLING AND CAP FOR STANDBY PUMPING CAPABILITIES.
8. ALL ELECTRICAL EQUIPMENT SHALL BE MANUFACTURED AND INSTALLED IN ACCORDANCE WITH NEMA REQUIREMENTS AND LOCAL LAWS.
9. THE LIFT STATION AND FORCE MAIN ARE TO BE INSTALLED IN ACCORDANCE WITH ALL LOCAL AND STATE PLUMBING CODES BY A LICENSED PLUMBER. ALL WORK IN THE RIGHT-OF-WAY SHALL BE PERFORMED BY A LICENSED UTILITY CONTRACTOR AND SHALL BE INSTALLED TO THE LOCAL UTILITY AUTHORITY'S STANDARDS.
10. THE CONTRACTOR SHALL BE COMPLETELY RESPONSIBLE FOR THE LAYOUT OF THE LIFT STATION, GRAVITY SEWER, AND FORCE MAIN. ANY DEVIATION FROM THE PRESCRIBED ALIGNMENT NECESSARY TO AVOID CONFLICTS SHALL NOT BE PERMITTED WITHOUT WRITTEN PERMISSION FROM THE ENGINEER OF RECORD.
11. INSTALLATION SHALL BE IN COMPLIANCE WITH THE LATEST EDITION OF THE STATE PLUMBING CODE.
12. THE PVC FORCE MAIN PIPE SHALL BE DR25 PER AWWA C900 OR SDR26 PER ASTM D2241 AND COLORED GREEN WITH 12 GAUGE GREEN INSULATED TRACER WIRE, UNLESS OTHERWISE NOTED.
13. THE FORCE MAIN SHALL BE PRESSURE TESTED TO 100 PSI PRIOR TO CONNECTING TO EXISTING SYSTEM.
14. THE CONTRACTOR WILL USE RESTRAINING DEVICES AT ALL MECHANICAL JOINTS INCLUDING FITTINGS, VALVES OR DEAD ENDS. IN-LINE VALVES SHALL BE RESTRAINED AT THE VALVE BODY ONLY. OTHER FITTINGS OR DEAD ENDS SHALL RECEIVE ADDITIONAL RESTRAINT AT ADJACENT PIPE JOINTS, IN BOTH DIRECTIONS, IN ACCORDANCE WITH THE PIPE JOINT RESTRAINT TABULATION IN THE PLANS. ALL RESTRAINT COST WILL BE INCLUDED IN THE UNIT PRICE PER FOOT OF THE PIPE.
15. A MINIMUM SEPARATION OF 10 FEET HORIZONTALLY OR 18 INCHES VERTICALLY MUST BE MAINTAINED BETWEEN WATER AND SEWER LINES. IF THIS SEPARATION IS NOT POSSIBLE, REFER TO THE SEPARATION/CONFLICT DETAIL.
16. THE UTILITY CONTRACTOR SHALL PROVIDE "AS-BUILT" DRAWINGS OF THE SAME SCALE AS THESE CONTRACT DRAWINGS, ONE COPY TO THE ENGINEER AND ONE COPY TO THE LOCAL UTILITIES AUTHORITIES. THESE DRAWINGS SHALL LOCATE ALL SEWER APPURTENANCES CONSTRUCTED AS PART OF THIS PROJECT. FINAL "AS-BUILT" DRAWINGS TO BE SUBMITTED TO THE ENGINEER WITHIN 30 DAYS AFTER SUBSTANTIAL COMPLETION OF WORK.
17. CONTRACTOR TO MAINTAIN ACCESS TO ALL PROPERTIES WITHIN THE PROJECT AREA AT ALL TIMES.
18. CONTRACTOR SHALL LOCATE, PROTECT AND SUPPORT ALL UTILITIES AND SERVICE LATERALS.

PUMP DESIGN DATA

MANUFACTURER	BARNES
TYPE PUMP	GRINDER
MODEL NUMBER	ZOGP
CAPACITY (GPM-THD)	29.6 GPM @50.3'
IMPELLER SIZE AND NUMBER	N/A
DISCHARGE PIPE SIZE	1.25"
HP-RATED RPM	2 HP / 3450 RPM
VOLT/PHASE	230 / 1 OR 3 (OWNER CHOICE)

WETWELL DATA

MANUFACTURER	AK INDUSTRIES
WET WELL DIAMETER	48"
WET WELL DEPTH	9.00'
INFLUENT DIA-EL	6'/16.00'
FORCE MAIN DIAMETER-EL	1.5"/17.00'
BOTTOM OF STATION EL	12.00'
PUMPS OFF EL	14.00'
LEAD PUMP ON EL	14.75'
LAG PUMP ON EL	15.25'
HIGH WATER ALARM EL	15.75'
GROUND EL	21.00'
TOP EL (WETWELL)	21.50'

RBA
REBOL-BATTLE & ASSOCIATES
 Civil Engineers and Surveyors
 2307 N. Ninth Avenue, Suite 300
 Tallahassee, Florida 32304
 Telephone: 904.438.0400 Fax: 904.438.0448
 EG 00009857 LB7918

UTILITY DETAILS

GULF BEACH SELF STORAGE
 8939 GULF BEACH HIGHWAY
 ESCAMBIA COUNTY, FLORIDA

REVISION	DATE	BY	DESCRIPTION

NOT FOR CONSTRUCTION

3126

STATE OF FLORIDA

PAUL A. BATTLE, P.E.

Dr. By: KAH
 Ck By: PAB
 Job No.: 2017.285
 Date: 06/15/2021

DRAWING No.
C4.2

This drawing is the property of Rebol-Battle & Associates and shall not be reproduced without written permission.

NO.	DATE	REVISION

PAUL A. BATTLE
 No. 53126
 STATE OF FLORIDA
 Dr. By: [Signature]
 Clerk: [Signature]
 Job No. 2017.285
 Date: 06/15/2021
 DRAWING No.
C5.0

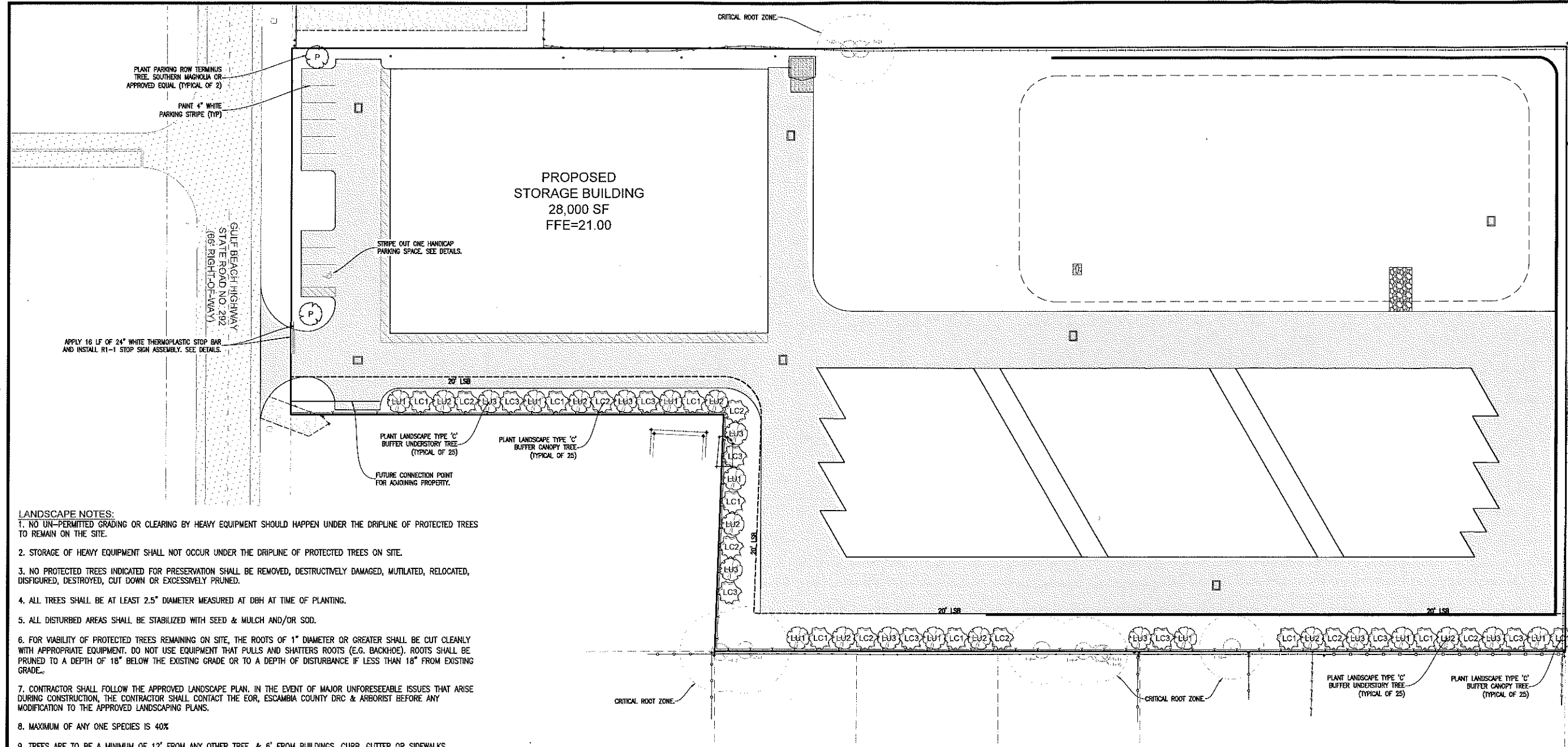

- LANDSCAPE NOTES:**
- NO UN-PERMITTED GRADING OR CLEARING BY HEAVY EQUIPMENT SHOULD HAPPEN UNDER THE DRIFLINE OF PROTECTED TREES TO REMAIN ON THE SITE.
 - STORAGE OF HEAVY EQUIPMENT SHALL NOT OCCUR UNDER THE DRIFLINE OF PROTECTED TREES ON SITE.
 - NO PROTECTED TREES INDICATED FOR PRESERVATION SHALL BE REMOVED, DESTRUCTIVELY DAMAGED, MUTILATED, RELOCATED, DISFIGURED, DESTROYED, CUT DOWN OR EXCESSIVELY PRUNED.
 - ALL TREES SHALL BE AT LEAST 2.5" DIAMETER MEASURED AT DBH AT TIME OF PLANTING.
 - ALL DISTURBED AREAS SHALL BE STABILIZED WITH SEED & MULCH AND/OR SOD.
 - FOR VIABILITY OF PROTECTED TREES REMAINING ON SITE, THE ROOTS OF 1" DIAMETER OR GREATER SHALL BE CUT CLEANLY WITH APPROPRIATE EQUIPMENT. DO NOT USE EQUIPMENT THAT PULLS AND SHATTERS ROOTS (E.G. BACKHOE). ROOTS SHALL BE PRUNED TO A DEPTH OF 18" BELOW THE EXISTING GRADE OR TO A DEPTH OF DISTURBANCE IF LESS THAN 18" FROM EXISTING GRADE.
 - CONTRACTOR SHALL FOLLOW THE APPROVED LANDSCAPE PLAN. IN THE EVENT OF MAJOR UNFORESEEABLE ISSUES THAT ARISE DURING CONSTRUCTION, THE CONTRACTOR SHALL CONTACT THE EOR, ESCAMBIA COUNTY DRC & ARBORIST BEFORE ANY MODIFICATION TO THE APPROVED LANDSCAPING PLANS.
 - MAXIMUM OF ANY ONE SPECIES IS 40%
 - TREES ARE TO BE A MINIMUM OF 12' FROM ANY OTHER TREE, & 6' FROM BUILDINGS, CURB, CUTTER OR SIDEWALKS.

LEGEND

	EXISTING ASPHALT
	EXISTING CONCRETE
	EXISTING GRAVEL
	EXISTING DIRT
	PROPOSED ASPHALT
	PROPOSED CONCRETE
	RIPRAP
	SOD OR SEED AND MULCH

EXISTING TREE

DENOTES PROPOSED PARKING ROW TERMINUS TREE. SOUTHERN MAGNOLIA OR APPROVED EQUAL. (MIN. 3" DIAMETER AT BREAST HEIGHT) (MATURE HEIGHT >30 FEET)

DENOTES PROPOSED LANDSCAPE BUFFER CANOPY TREE. LIVE OAK, SAND OAK, RED BUD OR APPROVAL EQUAL. TYP. OF 25 (MIN. 2" DIAMETER AT BREAST HEIGHT) (MATURE HEIGHT > 30 FT)

DENOTES SAND OAK (TYP OF 8)

DENOTES RED BUD (TYP OF 8)

DENOTES DOGWOOD (TYP OF 8)

DENOTES WAX MYRTLE (TYP OF 8)

DENOTES CRABAPPLE (TYP OF 8)

- STRIPPING & SIGN NOTES:**
- ALL PAVEMENT MARKINGS AND STRIPING SHALL BE THERMOPLASTIC AND INSTALLED ACCORDING TO FOOT STANDARD.
 - ALL NEEDED STRIPING DESTROYED DURING CONSTRUCTION SHALL BE RE-STRIPED ACCORDING TO FDOT STANDARD.
 - ALL LANES MUST BE OPEN FOR TRAFFIC DURING AN EVACUATION NOTICE OF A HURRICANE OR OTHER CATASTROPHIC EVENT AND SHALL REMAIN OPEN FOR THE DURATION OF THE EVACUATION OR EVENT AS DIRECTED BY THE LOCAL MAINTENANCE ENGINEER OR HIS DESIGNEE.
 - ALL SIGNS SHALL BE INSTALLED PER FDOT STANDARD, WIND ZONE No.1.

- LIST OF APPROVED TREES:**
- CANOPY**
- LIVE OAK - QUERCUS VIRGINIANA
 - SAND OAK - QUERCUS GEMINATA
 - SOUTHERN MAGNOLIA - MAGNOLIA GRANDIFLORA
 - BLACK TUPELO - NYSSA SYLVATICA
 - SWEETGUM - LIQUIDAMBAR STRYACIFLUA
 - RED BUD - CERCIS CANADENSIS
- MITIGATION TREE PLANTING NOTE**
- PER THE TREE MITIGATION TABLE FOUND ON SHEET C1.0, THE OWNER/DEVELOPER IS REQUIRED TO PLANT A TOTAL OF 108 INCHES OF TREES (43-2.5" TREES) ON SITE. THE NEWLY PLANTED TREES MUST BE FROM THE APPROVED SPECIES LIST AND HAVE A MINIMUM SIZE OF 2.5" DBH AT TIME OF PLANTING.
- MITIGATION CALCULATIONS DO NOT INCLUDE T-22 WHICH WAS REMOVED BY OTHERS.
- THE DEVELOPER CHOOSES TO PAY INTO THE ESCAMBIA COUNTY TREE FUND.
- 43 TREES X \$350.00 PER TREE = \$15,050.00

EXTERIOR SITE LIGHTING NOTE:

ALL EXTERIOR SITE LIGHTING SHALL ADHERE TO THE ESCAMBIA COUNTY LAND DEVELOPMENT CODE (SECTION 5-9.3).

FREESTANDING LIGHTING SHALL NOT BE PLACED WITHIN A 6-FOOT RADIUS, MINIMUM ROOTING AREA, OF ANY LANDSCAPED TREE.

TYPE 'C' LANDSCAPE BUFFER REQUIREMENTS:

ESCAMBIA COUNTY LDC SECTION: DSM 2-2

CANOPY TREE: 3.0 TREES PER 100 LF

UNDERSTORY TREE: 3.0 TREES PER 100 LF

SHRUBS: 30 SHRUBS PER 100 LF

CANOPY TREE: 3.0 PER 100 LF x 804 LF = 24.12 TREES (PLANT 25 TREES)

UNDERSTORY TREE: 3.0 PER 100 LF x 804 LF = 24.12 TREES (PLANT 25 TREES)

SHRUBS: 30 PER 100 LF x 804 LF = 241.2 SHRUBS (PLANT 242 SHRUBS)

SHRUBS TO BE PLANTED BETWEEN TREES.

LAND DISTURBING NOTE:

ALL TREES ARE TO REMAIN ONSITE AND ALL LAND DISTURBING ACTIVITIES, INCLUDING THE PLACEMENT OF FILL/FILL MATERIALS, GRADING, EXCAVATING, ETC. SHALL NOT OCCUR UNTIL SUCH TIME AS APPROPRIATE PERMIT(S) ARE ISSUED FOR THE PROPOSED WORK.

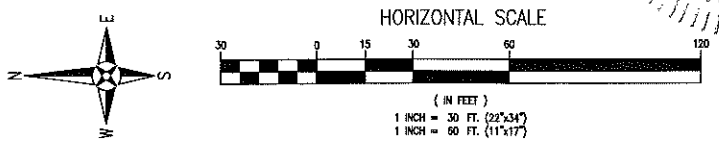

DRAWING IS THE PROPERTY OF REBOL-BATTLE & ASSOCIATES. AND MAY NOT BE REPRODUCED WITHOUT WRITTEN PERMISSION.

REVISION	DATE

Professional Engineer
 No. 53126
 DE. By: KMG
 JOB No. 2017-285
 Date: 06/15/2021

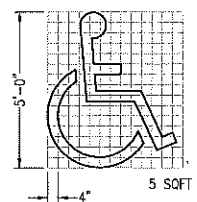

HANDICAP PAVEMENT SYMBOL
 N.T.S.



NOTES:
 1. TOP PORTION OF FTP 25 SHALL HAVE A REFLECTIVE BLUE BACKGROUND WITH WHITE REFLECTIVE SYMBOL AND BORDER.
 2. BOTTOM PORTION SHALL HAVE A REFLECTIVE WHITE BACKGROUND WITH BLACK OPAQUE LEGEND AND BORDER.
 3. FTP 25 MAY BE FABRICATED ON ONE PANEL OR TWO.
 4. SIGNS ARE TO BE MOUNTED AT STANDARD HEIGHT. (7' FROM PAVEMENT TO BOTTOM OF SIGN).
 5. SIGN COLUMN TO BE AS PER F.O.O.T. STANDARDS, INDEX NO'S 11860 AND 11865.
SIGN USED AS PER FLORIDA STATUTES
 FTP 25 Per FS 316.1955, FS 316.1956

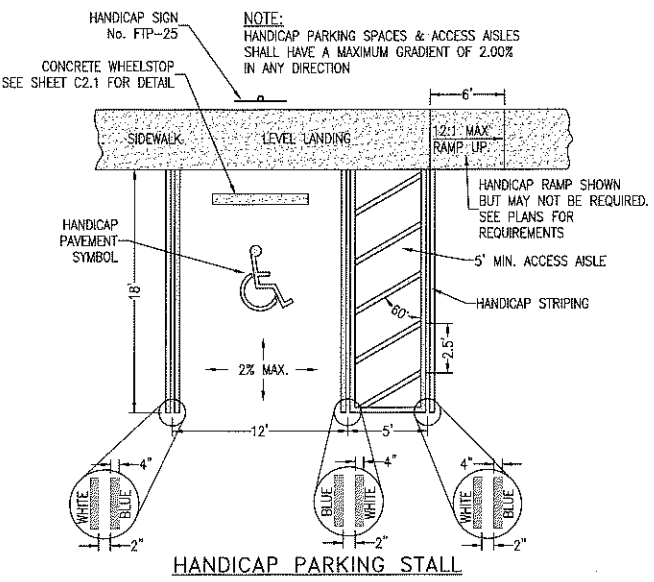

HANDICAP PARKING STALL DETAILS
 N.T.S.

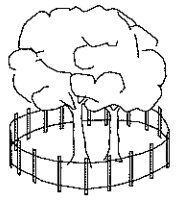

NOTE:
 ALL PROTECTED TREES AS SHOWN ON THE PLANS TO REMAIN ARE TO BE PROTECTED DURING CONSTRUCTION. THE CONTRACTOR SHALL INSTALL ORANGE CONSTRUCTION FENCING AT THE DRIP LINE OF EACH PROTECTED TREE BEFORE WORKING IN THE VICINITY OF THE TREE.
TREE BARRICADE DETAIL
 N.T.S.



FDOT STANDARD R1-1
2'-6" x 2'-6"
 N.T.S.

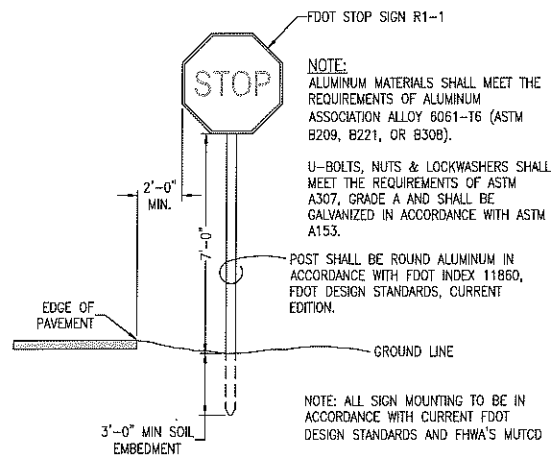

SIGN MOUNTING DETAIL
 N.T.S.

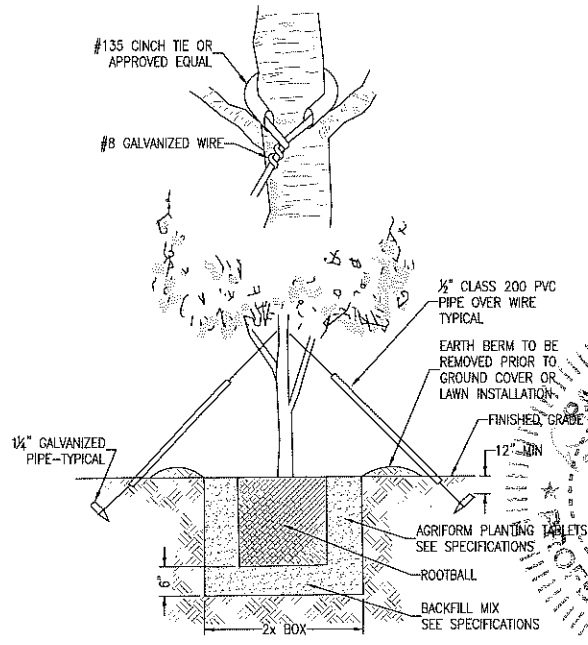

TREE PLANTING DETAIL
 N.T.S.